

ADDENDUM NO. 3

VILLAGE OF OHIO CITY Storm Drainage Improvements September 7, 2016

To: Planholders

From: Mote & Associates, Inc. Phone: (937) 548-7511
214 West Fourth Street Fax: (937) 548-7484
Greenville, Ohio 45331 E-mail: info@moteassociates.com

Re: Village of Ohio City
Storm Drainage Improvements

This Addendum forms a part of the Contract Documents and modifies the original Contract Documents dated August 2016 along with Addendum #1 of September 1, 2016 and Addendum #2 of September 2, 2016. Acknowledge receipt of all Addendums in the space provided on the Revised Bid Proposal Form #2. Failure to do so may subject the Bidder to disqualification.

CHANGES/CLARIFICATIONS TO THE BIDDING REQUIREMENTS:

1. Section 00 41 43, BID FORM

A. Base Bid: 81 L.F. of 60" Conduit shown on Plan Sheet #14 was included with the Type B quantity and should have been Type C. The "Bid Form" has been revised to reflect this change:

- Item 611, 60" Conduit, Type B (707.33) – Changed from 771 L.F. to 690 L.F.
- Item 611, 60" Conduit, Type C (707.33) – Changed from 382 L.F. to 463 L.F.

B. Alternate Bid #1:

- All of Item 611, 18" Conduit will now be Type B (707.33) for a total of 556 L.F.
- All of Item 611, 36" Conduit will now be Type B (707.33) for a total of 286 L.F.
- Item 611, 42" Conduit, Type B (707.33) – Changed from 523 L.F. to 136 L.F.
- Item 611, 42" Conduit, Type C (707.33) – Changed from 363 L.F. to 750 L.F.

2. Section 00 73 52, WAGE DETERMINATION SCHEDULE

The "Wage Determination Schedule" dated 08/26/2016 with 20 modifications has changed. A new "Wage Determination Schedule" dated 09/02/16 with 21 modifications is attached.

CHANGES/CLARIFICATIONS TO THE DETAIL CONSTRUCTION PLANS

3. Sheet #6 of 23 of the Construction Plans:

This sheet has been revised to add mounding around the proposed storm water detention basin to provide a place to use part of the excess excavation without hauling offsite. A calculation of ±15,000 C.Y. of fill is estimated to be used onsite. The bid quantity for excavation has not been changed. Note #4 of the General Notes (Sheet #3/23) applies to the work. It is still the Contractor's responsibility to verify estimated earthwork quantities and to adjust their unit price bid accordingly. Payment for the earthwork will be as bid for 'Excavation, As Per Plan'.

4. Trench Restoration Details for Alternate Bid #1:

Additional information relating to the Alternate Bid #1 trench restoration requirements for the storm sewer installation locations provided with Addendum #1 are as follows:

- A. The 42” Type ‘B’ (along Williams and Jefferson Streets) includes:
- 29’ of trench across an asphalt street (Williams St.)
- B. The 36” Type ‘B’ (along Shanes Street) includes:
- 39’ of trench across an asphalt street (Jefferson St. at Shanes St.)
 - 36’ of trench across an asphalt street (Banner St. at Shanes St.)
 - 4’ of trench across a 4’ wide concrete sidewalk (Jefferson/Shanes St. intersection)
 - 22’ of trench across an aggregate drive (north of Banner St.)
 - All of the 36” storm along Shanes St. is close enough to the Shanes St. pavement edge to require Type ‘B’ (± 2 ’ from center of pipe to pavement edge).
- C. The 24” Type ‘B’ (along Shanes Street) includes:
- 41’ of trench across an asphalt street (Hoffman St. at Shanes St.)
 - 56’ of trench across 2 asphalt drives (north of Hoffman St. at Shanes St.)
 - All of the 24” storm along Shanes St. is close enough to the Shanes St. pavement edge to require Type ‘B’ ($\pm 2-3$ ’ from center of pipe to pavement edge).
- D. The 18” Type ‘B’ (along Hoffman Street) includes:
- 56’ of trench across a 4’ wide concrete sidewalk
 - 40’ of trench across 2 concrete drives
 - 116’ of trench across aggregate drives
 - All of the 18” storm along Hoffman St. is close enough to the Hoffman St. pavement edge to require Type ‘B’ (± 3 ’ from center of pipe to pavement edge).
- E. The quantities of Type ‘B’ and Type ‘C’ storm sewer have been adjusted. The “Revised Bid Form #2” reflects the correct quantities to bid. This revised Form is attached hereto and is also being provided in an electronic Excel spreadsheet format for use, if desired.
- F. The proposed pavement/surface replacement over the storm sewer trenches shall be in accordance with the “Storm Sewer Trench Backfill Detail” on Sheet #2/23.
- G. The cost estimate for Alternate #1 is unchanged at \$239,000.00.

End of Addendum

Attachments: Section 00 41 43, Revised Bid Form #2
Section 00 73 52, Wage Determination Schedule
Revised Construction Plan Sheet #6
Section 00 41 43, Electronic Bid Attachment (Excel Document)

REVISED BID FORM #2

00 41 43

ARTICLE 1 - BID RECIPIENT

- 1.01 This Bid is submitted to: **[Village of Ohio City, 103 South Main Street, P.O. Box 246, Ohio City, Ohio 45874]**
- 1.02 The undersigned Bidder proposes and agrees, if this Bid is accepted, to enter into an Agreement with Owner in the form included in the Bidding Documents to perform all Work as specified or indicated in the Bidding Documents for the prices and within the times indicated in this Bid and in accordance with the other terms and conditions of the Bidding Documents.

ARTICLE 2 - BIDDER'S ACKNOWLEDGEMENTS

- 2.01 Bidder accepts all of the terms and conditions of the Instructions to Bidders, including without limitation those dealing with the disposition of Bid security. This Bid will remain subject to acceptance for 60 days after the Bid opening, or for such longer period of time that Bidder may agree to in writing upon request of Owner.

ARTICLE 3 - BIDDER'S REPRESENTATIONS

3.01 In submitting this Bid, Bidder represents that:

- A. Bidder has examined and carefully studied the Bidding Documents, and any data and reference items identified in the Bidding Documents, and hereby acknowledges receipt of the following Addenda:

<u>Addendum No.</u>	<u>Addendum, Date</u>
_____	_____
_____	_____
_____	_____

- B. Bidder has visited the Site, conducted a thorough, alert visual examination of the Site and adjacent areas, and become familiar with and satisfied itself as to the general, local, and Site conditions that may affect cost, progress, and performance of the Work.
- C. Bidder is familiar with and has satisfied itself as to all Laws and Regulations that may affect cost, progress, and performance of the Work.
- D. Bidder has carefully studied all: (1) reports of explorations and tests of subsurface conditions at or adjacent to the Site and all drawings of physical conditions relating to existing surface or subsurface structures at the Site that have been identified in the Supplementary Conditions, especially with respect to Technical Data in such reports and drawings, and (2) reports and drawings relating to Hazardous Environmental Conditions, if any, at or adjacent to the Site that have been identified in the Supplementary Conditions, especially with respect to Technical Data in such reports and drawings.
- E. Bidder has considered the information known to Bidder itself; information commonly known to contractors doing business in the locality of the Site; information and observations obtained from visits to the Site; the Bidding Documents; and any Site-related reports and drawings identified in the Bidding Documents, with respect to the effect of such information, observations, and

documents on (1) the cost, progress, and performance of the Work; (2) the means, methods, techniques, sequences, and procedures of construction to be employed by Bidder; and (3) Bidder's safety precautions and programs.

- F. Bidder agrees, based on the information and observations referred to in the preceding paragraph, that no further examinations, investigations, explorations, tests, studies, or data are necessary for the determination of this Bid for performance of the Work at the price bid and within the times required, and in accordance with the other terms and conditions of the Bidding Documents.
- G. Bidder is aware of the general nature of work to be performed by Owner and others at the Site that relates to the Work as indicated in the Bidding Documents.
- H. Bidder has given Engineer written notice of all conflicts, errors, ambiguities, or discrepancies that Bidder has discovered in the Bidding Documents, and confirms that the written resolution thereof by Engineer is acceptable to Bidder.
- I. The Bidding Documents are generally sufficient to indicate and convey understanding of all terms and conditions for the performance and furnishing of the Work.
- J. The submission of this Bid constitutes an incontrovertible representation by Bidder that Bidder has complied with every requirement of this Article, and that without exception the Bid and all prices in the Bid are premised upon performing and furnishing the Work required by the Bidding Documents.
- K. Bidder agrees that the contracting authority reserves the right to reject any or all bids, to waive any informalities or irregularities in the bids received, and to accept that bid which is considered lowest and to the best interest of the Owner.

ARTICLE 4 - BIDDER'S CERTIFICATION

4.01 Bidder certifies that:

- A. This Bid is genuine and not made in the interest of or on behalf of any undisclosed individual or entity and is not submitted in conformity with any collusive agreement or rules of any group, association, organization, or corporation;
- B. Bidder has not directly or indirectly induced or solicited any other Bidder to submit a false or sham Bid;
- C. No person interested in this Proposal is directly or indirectly interested in or connected with any other bid or proposal for the said work and no member of the Van Wert County Board of Commissioners and/or Village of Ohio City is directly or indirectly interested therein, or in any portion thereof, and he will, if required by the Van Wert County Board of Commissioners and/or the Village of Ohio City, execute and submit from himself as Principal Contractor and from any Subcontractor, the non-collusion affidavits as provided herein.
- D. Bidder has not solicited or induced any individual or entity to refrain from bidding; and
- E. Bidder has not engaged in corrupt, fraudulent, collusive, or coercive practices in competing for the Contract. For the purposes of this Paragraph 4.01.D:
 - 1. "corrupt practice" means the offering, giving, receiving, or soliciting of anything of value likely to influence the action of a public official in the bidding process;
 - 2. "fraudulent practice" means an intentional misrepresentation of facts made (a) to influence the bidding process to the detriment of Owner, (b) to establish bid prices at artificial non-competitive levels, or (c) to deprive Owner of the benefits of free and open competition;

3. "collusive practice" means a scheme or arrangement between two or more Bidders, with or without the knowledge of Owner, a purpose of which is to establish bid prices at artificial, non-competitive levels; and
4. "coercive practice" means harming or threatening to harm, directly or indirectly, persons or their property to influence their participation in the bidding process or affect the execution of the Contract.

ARTICLE 5 - BASIS OF BID

- 5.01 Bidder agrees that any item not specifically shown or called out on the plans or within the specifications, but is required to complete the work in place and fully operational, shall be included in the bid item that is most closely associated with that portion of the work.
- 5.02 Bidder will complete the Work in accordance with the Contract Documents for the following price(s) and will contract to do all the work and furnish all the materials called for by said plans and specifications, and in consideration thereof, to accept from the Owner as full payment for the completion of each specified item and any required maintenance thereof as hereinafter provided, for the following prices;

STORM DRAINAGE IMPROVEMENTS – BASE BID SCHEDULE

Item No.	Description	Est. Qty.	Unit	Material Price	Labor Price	Bid Unit Price	Total Bid Price
201	Clearing and Grubbing, As Per Plan	1	Lump				
202	Catch Basin Removed	17	Each				
202	Manhole Removed	6	Each				
203	Excavation, As Per Plan	31,500	C.Y.				
601	Rock Channel Protection, Type B w/Filter	8	C.Y.				
602	Headwall, As Per Plan (30" Pipe)	2	Each				
602	Headwall, As Per Plan (60" Pipe)	1	Each				
611	4" Storm Drain Repair	1	Each				
611	6" Storm Drain Repair	1	Each				
611	8" Storm Drain Repair	1	Each				
611	12" Storm Drain Repair	1	Each				
611	8" Conduit, Type B (707.33)	95	L.F.				
611	12" Conduit, Type C (707.33)	15	L.F.				
611	24" Conduit, Type B (707.33)	1,095	L.F.				
611	24" Conduit, Type C (707.33)	1,389	L.F.				
611	30" Conduit, Type C (707.33)	65	L.F.				
611	36" Conduit, Type B (707.33)	275	L.F.				
611	36" Conduit, Type C (707.33)	1,350	L.F.				

STORM DRAINAGE IMPROVEMENTS – BASE BID SCHEDULE (Continued)

Item No.	Description	Est. Qty.	Unit	Material Price	Labor Price	Bid Unit Price	Total Bid Price
611	42" Conduit, Type B (707.33)	343	L.F.				
611	42" Conduit, Type C (707.33)	291	L.F.				
611	48" Conduit, Type B (707.33)	87	L.F.				
611	48" Conduit, Type C (707.33)	393	L.F.				
611	54" Conduit, Type B (707.33)	52	L.F.				
611	60" Conduit, Type B (707.33)	690	L.F.				
611	60" Conduit, Type C (707.33)	463	L.F.				
611	48" x 42" Eccentric Reducer (707.33)	1	Each				
611	24" - 45° Bend (707.33)	1	Each				
611	8" x 8" Tee (707.33)	5	Each				
611	8" Cap (707.33)	9	Each				
611	Storm Manhole Type A (96" Dia. Base)	1	Each				
611	Storm Manhole Type A (90" Dia. Base)	3	Each				
611	Storm Manhole Type A (72" Dia. Base)	2	Each				
611	Storm Manhole Type A (60" Dia. Base)	1	Each				
611	Catch Basin, ODOT 2-5	2	Each				
611	Catch Basin, ODOT 2-4	8	Each				
611	Catch Basin, ODOT 2-3	17	Each				
614	Maintaining Traffic, As Per Plan	1	Lump				
624	Mobilization	1	Lump				
638	Fire Hydrant Relocated	2	Each				
638	Water Valve Relocated	5	Each				
659	Seeding and Mulching, Class 3B	31,700	S.Y.				
33 11 13	12" Water Line (AWWA C900)	40	L.F.				
33 11 13	8" Water Line (AWWA C900)	90	L.F.				
33 11 13	6" Water Line (AWWA C900)	20	L.F.				
33 11 13	12" x 12" Tee	1	Each				
33 11 13	12" x 8" Tee	1	Each				
33 11 13	12" - 45° Bend	4	Each				
33 11 13	12" x 8" Reducer	1	Each				
33 11 13	8" - 45° Bend	14	Each				
33 11 13	6" - 45° Bend	4	Each				

STORM DRAINAGE IMPROVEMENTS – BASE BID SCHEDULE (Continued)

Item No.	Description	Est. Qty.	Unit	Material Price	Labor Price	Bid Unit Price	Total Bid Price
33 11 13	12" Pipe Coupling	2	Each				
33 11 13	8" Pipe Coupling	5	Each				
33 12 13	Water Service Relocated	15	Each				
33 31 00	8" Sanitary Sewer (ASTM D3034)	65	L.F.				
33 31 00	8" - 45° Bend (ASTM D3034)	4	Each				
33 39 13	Core Drill Manhole and Connector	2	Each				
Spec.	6" Inserta Tee Connection	1	Each				
Spec.	8" Inserta Tee Connection	5	Each				
Spec.	24" Inserta Tee Connection	1	Each				
Spec.	8" Stainless Steel Shielded Shear Ring	2	Each				
Spec.	Concrete Low Flow Channel, As Per Plan	56	S.Y.				
Spec.	Check Valve Relocated	1	Each				
Spec.	30" Inline Check Valve	1	Each				
Spec.	Filter Fabric Fence, As Per Plan	1,050	L.F.				
Spec.	Guard Rail Removed and Reinstalled	1	Lump				
Total of All Base Bid Items						\$	

Total of Lump Sum and Unit Price Bids = Total Base Bid

(in words)

STORM DRAINAGE IMPROVEMENTS – ALTERNATE BID #1

Item No.	Description	Est. Qty.	Unit	Material Price	Labor Price	Bid Unit Price	Total Bid Price
201	Tree Removal (12"-36")	7	Each				
202	Catch Basin Removed	17	Each				
611	18" Conduit, Type B (707.33)	556	L.F.				
611	24" Conduit, Type B (707.33)	663	L.F.				
611	36" Conduit, Type B (707.33)	286	L.F.				

STORM DRAINAGE IMPROVEMENTS – ALTERNATE BID #1 (Continued)

Item No.	Description	Est. Qty.	Unit	Material Price	Labor Price	Bid Unit Price	Total Bid Price
611	42" Conduit, Type B (707.33)	136	L.F.				
611	42" Conduit, Type C (707.33)	750	L.F.				
611	Catch Basin, ODOT 2-2B	3	Each				
611	Catch Basin, ODOT 2-3	4	Each				
611	Catch Basin, ODOT 2-4	10	Each				
Total of All Alternate Bid #1 Items						\$	

Total of Lump Sum and Unit Price Bids = Total Alternate Bid #1

(in words)

Bidder acknowledges that:

- (1) Each Bid Unit Price includes an amount considered by Bidder to be adequate to cover Contractor's overhead and profit for each separately identified item;
- (2) Estimated quantities are not guaranteed, and are solely for the purpose of comparison of Bids, and final payment for all unit price Bid items will be based on actual quantities, determined as provided in the Contract Documents;
- (3) The Owner reserves the right to add or delete such quantities within the scope of the project as deemed necessary without in any way invalidating the Unit Prices bid; and
- (4) If this Proposal shall be accepted, Bidder will be prepared to discuss with the Van Wert County Board of Commissioners and the Village of Ohio City in detail any matters relating to special features and the methods proposed to be followed for the general conduct of the work, that within ten (10) days after "Notice of Award" the Contract Form with the Van Wert County Board of Commissioners and Village of Ohio City for performance of the work will be completed and Bidder will furnish a Contract Bond in an amount not less than one hundred percent (100%) of the total bid amount, and with sureties subject to the approval of the Van Wert County Board of Commissioners and Village of Ohio City as a guarantee of the faithful performance of this Contract; and that Bidder will also submit the required insurance policies.

ARTICLE 6 - TIME OF COMPLETION

- 6.01 Bidder agrees that **340' of 48" storm pipe along with Manhole #8 shown on Sheet #9 of the construction plans is required to be installed by October 31, 2016**, with the remainder of the work completed and ready for final payment in accordance with Paragraph 15.06 of the General Conditions on or before **July 31, 2017**.
- 6.02 Bidder accepts the provisions of the Agreement as to liquidated damages in the amount of \$1,000.00 for every consecutive day after the stated date in the Notice to Proceed and along with any time extension given per a Change Order and it may be retained from the monies which may be due.

ARTICLE 7 - ATTACHMENTS TO THIS BID

7.01 The following documents are submitted with and made a condition of this Bid:

- A. Required bid security consisting of a _____(Bond or Check) in the sum of \$_____ of the total bid amount accompanies this Proposal and the undersigned agrees that should he, after notice of "Award of Contract" fail to execute the Contract and Contract Bond as aforesaid, that his Certified Check or Bid Bond accompanying this Proposal shall be forfeited to the Van Wert County Board of Commissioners and the Village of Ohio City as liquidated damage caused by such failure.
- B. Affidavit for Corporation;
- C. Required Bidder Qualification Statement with supporting data;
- D. List of Proposed Subcontractors;
- E. Non-Collusion Affidavit(s);
- F. Required HUD Certifications; and
- G. OPWC EEO Certification

ARTICLE 8 - DEFINED TERMS

8.01 The terms used in this Bid with initial capital letters have the meanings stated in the Instructions to Bidders, the General Conditions, and the Supplementary Conditions.

ARTICLE 9 - BID SUBMITTAL

BIDDER: *[Indicate correct name of bidding entity]*

By: *[Signature]* _____

[Printed Name] _____

(If Bidder is a corporation, limited liability company, partnership or joint venture, attach evidence of authority to sign.)

Address for giving notices:

Telephone & Fax Numbers: _____

Contact Name and e-mail address: _____

Bidder's Federal ID No.: _____

WAGE DETERMINATION SCHEDULE

00 73 52

General Decision Number: OH160002 09/02/2016 OH2

Superseded General Decision Number: OH20150002

State: Ohio

Construction Types: Heavy and Highway

Counties: Ohio Statewide.

Heavy and Highway Construction Projects

Note: Under Executive Order (EO) 13658, an hourly minimum wage of \$10.15 for calendar year 2016 applies to all contracts subject to the Davis-Bacon Act for which the solicitation was issued on or after January 1, 2015. If this contract is covered by the EO, the contractor must pay all workers in any classification listed on this wage determination at least \$10.15 (or the applicable wage rate listed on this wage determination, if it is higher) for all hours spent performing on the contract in calendar year 2016. The EO minimum wage rate will be adjusted annually. Additional information on contractor requirements and worker protections under the EO is available at www.dol.gov/whd/govcontracts.

Modification Number	Publication Date
0	01/08/2016
1	01/15/2016
2	02/05/2016
3	02/19/2016
4	03/04/2016
5	03/18/2016
6	04/01/2016
7	04/08/2016
8	04/22/2016
9	05/06/2016
10	05/13/2016
11	05/27/2016
12	06/17/2016
13	06/24/2016
14	07/01/2016
15	07/08/2016
16	07/15/2016
17	07/22/2016
18	08/12/2016
19	08/19/2016
20	08/26/2016
21	09/02/2016

BRKY0007-003 06/01/2011

LAWRENCE

	Rates	Fringes
Bricklayer, Stonemason.....	\$ 28.29	16.80

BROH0001-001 07/01/2015

DEFIANCE, FULTON (Excluding Fulton, Amboy & Swan Creek Townships), HENRY (Excluding Monroe, Bartlow, Liberty, Washington, Richfield, Marion, Damascus & Townships & that part of Harrison Township outside corporate limits of city of Napoleon), PAULDING, PUTNAM and WILLIAMS COUNTIES

	Rates	Fringes
Bricklayer, Stonemason.....	\$ 30.10	14.01

BROH0001-004 06/01/2015

	Rates	Fringes
CEMENT MASON/CONCRETE FINISHER...	\$ 29.48	12.62

BROH0003-002 07/01/2015

FULTON (Townships of Amboy, Swan Creek & Fulton), HENRY (Townships of Washington, Damascus, Richfield, Bartlow, Liberty, Harrison, Monroe, & Marion), LUCAS and WOOD (Townships of Perrysburg, Ross, Lake, Troy, Freedom, Montgomery, Webster, Center, Portage, Middleton, Plain, Liberty, Henry, Washington, Weston, Milton, Jackson & Grand Rapids) COUNTIES

	Rates	Fringes
Bricklayer, Stonemason.....	\$ 28.85	17.91

BROH0005-003 05/01/2015

CUYAHOGA, LORAIN & MEDINA (Hinckley, Granger, Brunswick, Liverpool, Montville, York, Homer, Harrisville, Chatham, Litchfield & Spencer Townships and the city of Medina)

	Rates	Fringes
BRICKLAYER		
BRICKLAYERS; CAULKERS;		
CLEANERS; POINTERS; &		
STONEMASONS.....	\$ 33.81	13.86
SANDBLASTERS.....	\$ 34.06	13.86
SEWER BRICKLAYERS & STACK		
BUILDERS.....	\$ 34.31	13.86
SWING SCAFFOLDS.....	\$ 34.56	13.86

BROH0006-005 06/01/2015

CARROLL, COLUMBIANA (Knox, Butler, West & Hanover Townships), STARK & TUSCARAWAS

	Rates	Fringes
Bricklayer, Stonemason.....	\$ 29.48	12.62

 BROH0007-005 06/01/2015

PORTAGE & SUMMIT

	Rates	Fringes
BRICKLAYER.....	\$ 30.24	15.21

 BROH0007-010 06/01/2015

PORTAGE & SUMMIT

	Rates	Fringes
MASON - STONE.....	\$ 29.48	12.62

 BROH0008-001 06/01/2015

COLUMBIANA (Salem, Perry, Fairfield, Center, Elk Run, Middleton, & Unity Townships and the city of New Waterford), MAHONING & TRUMBULL

	Rates	Fringes
BRICKLAYER.....	\$ 27.15	18.19

 BROH0009-002 06/01/2015

BELMONT & MONROE COUNTIES and the Townships of Warren & Mt. Pleasant and the Village of Dillonvale in JEFFERSON COUNTY

	Rates	Fringes
Bricklayer, Stonemason.....	\$ 29.48	12.62
Refractory.....	\$ 29.48	12.62

 BROH0010-002 06/01/2015

COLUMBIANA (St. Clair, Madison, Wayne, Franklin, Washington, Yellow Creek & Liverpool Townships) & JEFFERSON (Brush Creek & Saline Townships)

	Rates	Fringes
Bricklayer, Stonemason.....	\$ 29.48	12.62

 BROH0014-002 06/01/2015

HARRISON & JEFFERSON (Except Mt. Pleasant, Warren, Brush Creek, Saline & Salineville Townships & the Village of Dillonvale)

	Rates	Fringes
Bricklayer, Stonemason.....	\$ 29.48	12.62

BROH0016-002 05/01/2015

ASHTABULA, GEAUGA, and LAKE COUNTIES

	Rates	Fringes
Bricklayer, Stonemason.....	\$ 32.03	14.9

BROH0018-002 06/01/2015

BROWN, BUTLER, CLERMONT, HAMILTON, PREBLE (Gasper, Dixon, Israel, Lanier, Somers & Gratis Townships) & WARREN COUNTIES:

	Rates	Fringes
Bricklayer, Stonemason.....	\$ 29.48	12.62

BROH0022-004 06/01/2015

CHAMPAIGN, CLARK, CLINTON, DARKE, GREENE, HIGHLAND, LOGAN, MIAMI, MONTGOMERY, PREBLE (Jackson, Monroe, Harrison, Twin, Jefferson & Washington Townships) and SHELBY COUNTIES

	Rates	Fringes
Bricklayer, Stonemason.....	\$ 29.48	12.62

BROH0032-001 06/01/2015

GALLIA & MEIGS

	Rates	Fringes
Bricklayer, Stonemason.....	\$ 29.48	12.62

BROH0035-002 06/01/2015

ALLEN, AUGLAIZE, MERCER and VAN WERT COUNTIES

	Rates	Fringes
Bricklayer, Stonemason.....	\$ 29.48	12.62

BROH0039-002 06/01/2015

ADAMS & SCIOTO

	Rates	Fringes
Bricklayer, Stonemason.....	\$ 30.00	18.60

BROH0040-003 06/01/2015

ASHLAND, CRAWFORD, HARDIN, HOLMES, MARION, MORROW, RICHLAND, WAYNE and WYANDOT (Except Crawford, Ridge, Richland & Tymochtee Townships) COUNTIES

	Rates	Fringes
Bricklayer, Stonemason.....	\$ 29.09	17.18

FOOTNOTE: Layout Man and Sawman rate: \$1.00 per hour above journeyman rate.
 Free standing stack work ground level to top of stack;
 Sandblasting and laying of carbon masonry material in swing stage and/or scaffold; Ramming and spading of plastics and gunniting: \$1.50 per hour above journeyman rate.
 "Hot" work: \$2.50 above journeyman rate.

BROH0044-002 06/01/2015

	Rates	Fringes
Bricklayer, Stonemason COSHOCTON, FAIRFIELD, GUERNSEY, HOCKING, KNOX, KICKING, MORGAN, MUSKINGUM, NOBLE (Beaver, Buffalo, Seneca & Wayne Townships) & PERRY COUNTIES:.....	\$ 29.48	12.62

BROH0045-002 06/01/2015

FAYETTE, JACKSON, PIKE, ROSS and VINTON COUNTIES

	Rates	Fringes
Bricklayer, Stonemason.....	\$ 30.11	13.75

BROH0046-002 06/01/2015

ERIE, HANCOCK, HURON, OTTAWA, SANDUSKY, SENECA, WOOD (Perry & Bloom Townships) and WYANDOT (Tymochtee, Crawford, Ridge & Richland Townships) COUNTIES & the Islands of Lake Erie north of Sandusky

	Rates	Fringes
Bricklayer, Stonemason.....	\$ 29.60	16.88

FOOTNOTE: Layout Man and Sawman rate: \$1.00 per hour above journeyman rate.
 Free standing stack work ground level to top of stack;
 Sandblasting and laying of carbon masonry material in swing stage and/or scaffold; Ramming and spading of plastics and gunniting: \$1.50 per hour above journeyman rate.
 "Hot" work: \$2.50 above journeyman rate.

BROH0052-001 06/01/2015

ATHENS COUNTY

	Rates	Fringes
Bricklayer, Stonemason.....	\$ 29.48	12.62

BROH0052-003 06/01/2015

NOBLE (Brookfield, Noble, Center, Sharon, Olive, Enoch, Stock,

Jackson, Jefferson & Elk Townships) and WASHINGTON COUNTIES

	Rates	Fringes
Bricklayer, Stonemason.....	\$ 28.10	15.80

BROH0055-003 06/01/2015		

DELAWARE, FRANKLIN, MADISON, PICKAWAY and UNION COUNTIES

	Rates	Fringes
Bricklayer, Stonemason.....	\$ 28.12	15.74

CARP0003-004 05/01/2014		

MAHONING & TRUMBULL

	Rates	Fringes
CARPENTER.....	\$ 25.61	15.10

CARP0069-003 05/01/2014		

CARROLL, STARK, TUSCARAWAS & WAYNE

	Rates	Fringes
CARPENTER.....	\$ 25.50	13.67

CARP0069-006 05/01/2014		

COSHOCTON, HOLMES, KNOX & MORROW

	Rates	Fringes
CARPENTER.....	\$ 23.66	13.05

CARP0171-002 05/01/2014		

BELMONT, COLUMBIANA, HARRISON, JEFFERSON & MONROE

	Rates	Fringes
CARPENTER.....	\$ 26.02	15.49

CARP0200-002 05/01/2016		

ADAMS, ATHENS, DELAWARE, FAIRFIELD, FAYETTE, FRANKLIN, GALLIA, GUERNSEY, HIGHLAND, HOCKING, JACKSON, LAWRENCE, LICKING, MADISON, MARION, MEIGS, MORGAN, MUSKINGUM, NOBLE, PERRY, PICKAWAY, PIKE, ROSS, SCIOTO, UNION, VINTON and WASHINGTON COUNTIES

	Rates	Fringes
CARPENTER.....	\$ 28.70	15.39
Diver.....	\$ 39.41	10.40
PILEDRIVERMAN.....	\$ 28.70	15.39

CARP0248-005 07/01/2008		

LUCAS & WOOD

Rates Fringes

CARPENTER.....\$ 27.27 14.58

CARP0248-008 07/01/2008

Rates Fringes

CARPENTER

DEFIANCE, FULTON, HANCOCK,
HENRY, PAULDING & WILLIAMS
COUNTIES.....\$ 23.71

13.28

CARP0254-002 05/01/2014

ASHTABULA, CUYAHOGA, GEAUGA & LAKE

Rates Fringes

CARPENTER.....\$ 31.61 14.46

CARP0372-002 07/01/2008

ALLEN, AUGLAIZE, HARDIN, MERCER, PUTNAM & VAN WERT

Rates Fringes

CARPENTER.....\$ 23.18 13.28

CARP0639-003 05/01/2014

MEDINA, PORTAGE & SUMMIT

Rates Fringes

CARPENTER.....\$ 29.59 14.64

CARP0735-002 05/01/2014

ASHLAND, ERIE, HURON, LORAIN & RICHLAND

Rates Fringes

CARPENTER.....\$ 24.80 13.29

CARP1311-001 05/01/2014

BROWN, BUTLER, CHAMPAIGN, CLARK, CLERMONT, CLINTON, DARKE,
GREENE, HAMILTON, LOGAN, MIAMI, MONTGOMERY, PREBLE, SHELBY &
WARREN

Rates Fringes

Carpenter & Piledrivermen.....\$ 27.39 14.33

Diver.....\$ 40.58 9.69

CARP1393-002 07/01/2008

CRAWFORD, DEFIANCE, FULTON, HANCOCK, HENRY, LUCAS, OTTAWA,
PAULDING, SANDUSKY, SENECA, WILLIAMS & WOOD

Rates Fringes

Piledrivermen & Diver's Tender...\$ 27.30 16.05

DIVERS - \$250.00 per day

CARP1393-003 07/01/2008

ALLEN, AUGLAIZE, HARDIN, MERCER, PUTNAM, VAN WERT & WYANDOT

	Rates	Fringes
Piledrivermen & Diver's Tender...	\$ 25.15	15.92

DIVERS - \$250.00 per day

CARP1871-006 06/01/2013

BELMONT, HARRISON, & MONROE

	Rates	Fringes
Diver, Wet.....	\$ 47.07	13.92
Piledrivermen; Diver, Dry.....	\$ 31.38	13.92

CARP1871-008 06/01/2013

ASHLAND, ASHTABULA, CUYAHOGA, ERIE, GEAUGA, HURON, LAKE,
LORAIN, MEDINA, PORTAGE, RICHLAND & SUMMIT

	Rates	Fringes
Diver, Wet.....	\$ 44.22	15.49
Piledrivermen; Diver, Dry.....	\$ 29.48	15.49

CARP1871-014 06/01/2013

CARROLL, STARK, TUSCARAWAS & WAYNE

	Rates	Fringes
Diver, Wet.....	\$ 37.40	13.81
Piledrivermen; Diver, Dry.....	\$ 24.93	13.81

CARP1871-015 06/01/2013

COSHOCTON, HOLMES, KNOX & MORROW

	Rates	Fringes
Diver, Wet.....	\$ 36.53	12.96
Piledrivermen; Diver, Dry.....	\$ 24.35	12.96

CARP1871-017 06/01/2013

MAHONING & TRUMBULL

	Rates	Fringes
Diver, Wet.....	\$ 39.44	14.16
Piledrivermen; Diver, Dry.....	\$ 26.29	14.16

CARP2235-012 01/01/2014

COLUMBIANA & JEFFERSON

	Rates	Fringes
PILEDRIVERMAN.....	\$ 31.74	16.41

 CARP2239-001 07/01/2008

CRAWFORD, OTTAWA, SANDUSKY, SENECA & WYANDOT

	Rates	Fringes
CARPENTER.....	\$ 23.71	13.28

 ELEC0008-002 05/25/2015

DEFIANCE, FULTON, HANCOCK, HENRY, LUCAS, OTTAWA, PAULDING,
 PUTNAM, SANDUSKY, SENECA, WILLIAMS & WOOD

	Rates	Fringes
CABLE SPLICER.....	\$ 38.98	18.96
ELECTRICIAN.....	\$ 37.12	4.5%+18.04

 ELEC0032-003 06/01/2014

ALLEN, AUGLAIZE, HARDIN, LOGAN, MERCER, SHELBY, VAN WERT &
 WYANDOT (Crawford, Jackson, Marseilles, Mifflin, Ridgeland,
 Ridge & Salem Townships)

	Rates	Fringes
ELECTRICIAN.....	\$ 28.32	15.18

 ELEC0032-004 06/01/1998

ALLEN, HARDIN, VAN WERT & WYANDOT (Crawford, Jackson,
 Marseilles, Mifflin, Richland, Ridge & Salem Townships)

	Rates	Fringes
Line Construction		
Equipment Operator.....	\$ 20.27	4.12+a
Groundman Truck Driver.....	\$ 14.43	3.63+a
Lineman.....	\$ 22.52	4.31+a

FOOTNOTE: a. Half day's Paid Holiday: The last 4 hours of
 the workday prior to Christmas or New Year's Day

 ELEC0038-002 04/25/2016

CUYAHOGA, GEAUGA (Bainbridge, Chester & Russell Townships) &
 LORAIN (Columbia Township)

	Rates	Fringes
ELECTRICIAN		
Excluding Sound & Communications Work.....	\$ 37.13	20.38

FOOTNOTES;
 a. 6 Paid Holidays: New Year's Day; Memorial Day; July 4th;

Labor Day; Thanksgiving Day; & Christmas Day
 b. 1 week's paid vacation for 1 year's service; 2 weeks' paid vacation for 2 or more years' service

 ELEC0038-008 04/25/2016

CUYAHOGA, GEAUGA (Bainbridge, Chester & Russell Townships) & LORAIN (Columbia Township)

	Rates	Fringes
Sound & Communication Technician		
Communications Technician...\$	26.05	10.90+a+b
Installer Technician.....\$	24.80	10.86+a+b

FOOTNOTES;

a. 6 Paid Holidays: New Year's Day; Memorial Day; July 4th; Labor Day; Thanksgiving Day; & Christmas Day
 b. 1 week's paid vacation for 1 year's service; 2 weeks' paid vacation for 2 or more years' service

 ELEC0064-003 11/30/2015

COLUMBIANA (Butler, Fairfield, Perry, Salem & Unity Townships) MAHONING (Austintown, Beaver, Berlin, Boardman, Canfield, Ellsworth, Coitsville, Goshen, Green, Jackson, Poland, Springfield & Youngstown Townships), & TRUMBULL (Hubbard & Liberty Townships)

	Rates	Fringes
ELECTRICIAN.....\$	32.02	13.74

 ELEC0071-001 12/28/2015

ASHLAND, CHAMPAIGN, CLARK, COSHOCTON, CRAWFORD, DELAWARE, FAIRFIELD, FAYETTE, FRANKLIN, GUERNSEY, HIGHLAND, HOCKING, JACKSON (Coal, Jackson, Liberty, Milton, Washington & Wellston Townships), KNOX, LICKING, MADISON, MARION, MONROE, MORGAN, MORROW, MUSKINGUM, NOBLE, PERRY, PICKAWAY, PIKE (Beaver, Benton, Jackson, Mifflin, Pebble, Peepee, Perry & Seal Townships), RICHLAND, ROSS, TUSCARAWAS (Auburn, Bucks, Clay, Jefferson, Oxford, Perry, Salem, Rush, Washington & York Townships), UNION, VINTON (Clinton, Eagle, Elk, Harrison, Jackson, Richland & Swan Townships), and WASHINGTON COUNTIES

	Rates	Fringes
Line Construction		
Equipment Operators.....\$	32.24	12.34
Groundmen.....\$	23.28	10.37
Linemen & Cable Splicers....\$	35.82	13.13

 ELEC0071-004 12/28/2015

AUGLAIZE, CLINTON, DARKE, GREENE, LOGAN, MERCER, MIAMI, MONTGOMERY, PREBLE, and SHELBY COUNTIES

	Rates	Fringes
Line Construction		
Equipment Operator.....	\$ 32.24	12.34
Groundman.....	\$ 23.28	10.37
Lineman & Cable Splicers....	\$ 35.82	13.13

 ELEC0071-005 12/29/2015

ASHTABULA, CUYAHOGA, GEAUGA, LAKE & LORAIN

	Rates	Fringes
LINE CONSTRUCTION: Equipment Operator		
DOT/Traffic Signal & Highway Lighting Projects...	\$ 31.30	13.07
Municipal Power/Transit Projects.....	\$ 37.34	14.58
LINE CONSTRUCTION: Groundman		
DOT/Traffic Signal & Highway Lighting Projects...	\$ 24.34	11.33
Municipal Power/Transit Projects.....	\$ 29.05	12.51
LINE CONSTRUCTION: Linemen/Cable Splicer		
DOT/Traffic Signal & Highway Lighting Projects...	\$ 34.78	13.94
Municipal Power/Transit Projects.....	\$ 41.49	15.61

 ELEC0071-008 12/28/2015

COLUMBIANA, MAHONING, and TRUMBULL COUNTIES

	Rates	Fringes
Line Construction		
Equipment Operator.....	\$ 32.24	12.34
Groundman.....	\$ 23.28	10.37
Lineman & Cable Splicers....	\$ 35.82	13.13

 ELEC0071-010 12/28/2015

BELMONT, CARROLL, HARRISON, HOLMES, JEFFERSON, MEDINA, PORTAGE, STARK, SUMMIT, and WAYNE COUNTIES

	Rates	Fringes
Line Construction		
Equipment Operator.....	\$ 32.24	12.34
Groundman.....	\$ 23.28	10.37
Lineman & Cable Splicers....	\$ 35.82	13.13

 ELEC0071-013 12/28/2015

BROWN, BUTLER, CLERMONT, HAMILTON, and WARREN COUNTIES

	Rates	Fringes
Line Construction		
Equipment Operator.....	\$ 32.24	12.34

Groundman.....	\$ 23.28	10.37
Lineman & Cable Splicers....	\$ 35.82	13.13

 ELEC0071-014 12/28/2015

ADAMS, ATHENS, GALLIA, JACKSON (Bloomfield, Franklin, Hamilton, Lick, Jefferson, Scioto & Madison Townships), LAWRENCE, MEIGS, PIKE (Camp Creek, Marion, Newton, Scioto, Sunfish & Union Townships), SCIOTO & VINTON (Brown, Knox, Madison, Vinton & Wilkesville Townships)

	Rates	Fringes
Line Construction		
Equipment Operator.....	\$ 32.24	12.34
Groundman.....	\$ 23.28	10.37
Lineman & Cable Splicers....	\$ 35.82	13.13

 ELEC0082-002 11/30/2015

CLINTON, DARKE, GREENE, MIAMI, MONTGOMERY, PREBLE & WARREN (Wayne, Clear Creek & Franklin Townships)

	Rates	Fringes
ELECTRICIAN.....	\$ 28.60	17.60

 ELEC0082-006 11/30/2015

CLINTON, DARKE, GREENE, MIAMI, MONTGOMERY, PREBLE & WARREN (Wayne, Clear Creek & Franklin Townships)

	Rates	Fringes
Sound & Communication Technician		
Cable Puller.....	\$ 10.24	4.91
Installer/Technician.....	\$ 22.75	10.56

 ELEC0129-003 02/29/2016

LORAIN (Except Columbia Township) & MEDINA (Litchfield & Liverpool Townships)

	Rates	Fringes
ELECTRICIAN.....	\$ 32.35	16.24

 ELEC0129-004 02/29/2016

ERIE & HURON (Lyme, Ridgefield, Norwalk, Townsend, Wakeman, Sherman, Peru, Bronson, Hartland, Clarksfield, Norwich, Greenfield, Fairfield, Fitchville & New London Townships)

	Rates	Fringes
ELECTRICIAN.....	\$ 32.35	16.24

 ELEC0141-003 09/01/2015

BELMONT COUNTY	Rates	Fringes
CABLE SPLICER.....	\$ 32.25	23.67

ELECTRICIAN.....\$ 28.80 23.06

ELEC0212-003 06/06/2016

BROWN, CLERMONT & HAMILTON

	Rates	Fringes
Sound & Communication Technician.....	\$ 27.47	17.78

ELEC0212-005 06/06/2016

BROWN, CLERMONT, and HAMILTON COUNTIES

	Rates	Fringes
ELECTRICIAN.....	\$ 27.47	17.78

ELEC0245-003 08/31/2015

DEFIANCE, FULTON, HANCOCK, HENRY, HURON, LUCAS, OTTAWA, PAULDING, PUTNAM, SANDUSKY, SENECA, WILLIAMS, and WOOD COUNTIES

	Rates	Fringes
Line Construction		
Cable Splicer.....	\$ 42.19	25.20%+\$5.00+a
Groundman/Truck Driver.....	\$ 16.05	25.20%+\$5.00+a
Heli-arc Welding.....	\$ 36.99	25.20%+\$5.00+a
Lineman.....	\$ 36.69	25.20%+\$5.00+a
Operator - Class 1.....	\$ 29.35	25.20%+\$5.00+a
Operator - Class 2.....	\$ 25.68	25.20%+\$5.00+a
Traffic Signal & Lighting Technician.....	\$ 33.02	25.20%+\$5.00+a

FOOTNOTE: a. 6 Observed Holidays: New Year's Day; Memorial Day; Independence Day; Labor Day; Thanksgiving Day; & Christmas Day. Employees who work on a holiday shall be paid at a rate of double their applicable classified straight-time rates for the work performed on such holiday.

ELEC0245-004 08/31/2015

ERIE COUNTY

	Rates	Fringes
Line Construction		
Cable Splicer.....	\$ 42.19	25.20%+\$5.00+a
Groundman/Truck Driver.....	\$ 16.05	25.20%+\$5.00+a
Lineman.....	\$ 36.69	25.20%+\$5.00+a
Operator - Class 1.....	\$ 29.35	25.20%+\$5.00+a
Operator - Class 2.....	\$ 25.68	25.20%+\$5.00+a

FOOTNOTE: a. 6 Observed Holidays: New Year's Day; Memorial Day; Independence Day; Labor Day; Thanksgiving Day; & Christmas Day. Employees who work on a holiday shall be paid at a rate of double their applicable classified straight-time rates for the work performed on such holiday.

ELEC0246-006 10/29/2012

	Rates	Fringes
ELECTRICIAN.....	\$ 33.00	26.16

ELEC0306-005 05/30/2016

MEDINA (Brunswick, Chatham, Granger, Guilford, Harrisville, Hinckley, Homer, Lafayette, Medina, Montville, Sharon, Spencer, Wadsworth, Westfield & York Townships), PORTAGE (Atwater, Aurora, Brimfield, Deerfield, Franklin, Mantua, Randolph, Ravenna, Rootstown, Shalersville, Streetsboro & Suffield Townships), SUMMIT & WAYNE (Baughman, Canaan, Chester, Chippewa, Congress, Green, Milton, & Wayne Townships)

	Rates	Fringes
CABLE SPLICER.....	\$ 36.87	16.56
ELECTRICIAN.....	\$ 33.79	5%+16.41

ELEC0317-002 05/28/2014

GALLIA & LAWRENCE	Rates	Fringes
CABLE SPLICER.....	\$ 32.68	18.13
ELECTRICIAN.....	\$ 32.62	21.45

ELEC0540-003 06/05/1997

TUSCARAWAS COUNTY (North of Auburn, Clay, Rush & York Townships)

Line Construction	Rates	Fringes
Groundman; & Truck Driver...	\$ 14.65	8.18
Line Equipment Operator.....	\$ 19.02	8.69
Lineman; & Cable Splicer....	\$ 21.86	9.01

ELEC0540-005 12/28/2015

CARROLL (Northern half, including Fox, Harrison, Rose & Washington Townships), COLUMBIANA (Knox Township), HOLMES, MAHONING (Smith Township), STARK, TUSCARAWAS (North of Auburn, Clay, Rush & York Townships), and WAYNE (South of Baughman, Chester, Green & Wayne Townships) COUNTIES

	Rates	Fringes
ELECTRICIAN.....	\$ 30.04	21.78

ELEC0573-003 06/01/2015

ASHTABULA (Colebrook, Wayne, Williamsfield, Orwell & Windsor Townships), GEAUGA (Auburn, Middlefield, Parkman & Troy Townships), MAHONING (Milton Township), PORTAGE (Charlestown, Edinburg, Freedom, Hiram, Nelson, Palmyra, Paris & Windham Townships), and TRUMBULL (Except Liberty & Hubbard Townships)

	Rates	Fringes
ELECTRICIAN.....	\$ 30.57	16.85

 ELEC0575-001 05/30/2016

ADAMS, FAYETTE, HIGHLAND, HOCKING, JACKSON (Bloomfield, Franklin, Hamilton, Jefferson, Lick, Madison, Scioto, Coal, Jackson, Liberty, Milton & Washington Townships), PICKAWAY (Deer Creek, Perry, Pickaway, Salt Creek & Wayne Townships), PIKE (Beaver, Benton, Jackson, Mifflin, Pebble, PeePee, Perry, Seal, Camp Creek, Newton, Scioto, Sunfish, Union & Marion Townships), ROSS, SCIOTO & VINTON (Clinton, Eagle, Elk, Harrison, Jackson, Richland & Swan Townships)

	Rates	Fringes
ELECTRICIAN.....	\$ 31.85	14.02

 ELEC0648-001 08/31/2015

BUTLER and WARREN COUNTIES (Deerfield, Hamilton, Harlan, Massie, Salem, Turtle Creek, Union & Washington Townships)

	Rates	Fringes
CABLE SPLICER.....	\$ 29.39	17.17
ELECTRICIAN.....	\$ 28.89	17.15

 ELEC0673-004 06/01/2015

ASHTABULA (Excluding Orwell, Colebrook, Williamsfield, Wayne & Windsor Townships), GEAUGA (Burton, Chardon, Claridon, Hambden, Huntsburg, Montville, Munson, Newbury & Thompson Townships) and LAKE COUNTIES

	Rates	Fringes
CABLE SPLICER.....	\$ 33.29	17.11
ELECTRICIAN.....	\$ 33.37	18.05

 ELEC0683-002 05/30/2016

CHAMPAIGN, CLARK, DELAWARE, FAIRFIELD, FRANKLIN, MADISON, PICKAWAY (Circleville, Darby, Harrison, Jackson, Madison, Monroe, Muhlenberg, Scioto, Walnut & Washington Townships), and UNION COUNTIES

	Rates	Fringes
CABLE SPLICER.....	\$ 31.45	15.85
ELECTRICIAN.....	\$ 31.85	17.38

 ELEC0688-003 05/30/2016

ASHLAND, CRAWFORD, HURON (Richmond, New Haven, Ripley & Greenwich Townships), KNOX (Liberty, Clinton, Union, Howard, Monroe, Middleberry, Morris, Wayne, Berlin, Pike, Brown & Jefferson Townships), MARION, MORROW, RICHLAND and WYANDOT

(Sycamore, Crane, Eden, Pitt, Antrim & Tymochtee Townships)
COUNTIES

	Rates	Fringes
ELECTRICIAN.....	\$ 28.16	16.34

ELEC0972-002 06/01/2015

ATHENS, MEIGS, MONROE, MORGAN, NOBLE, VINTON (Brown, Knox, Madison, Vinton & Wilkesville Townships), and WASHINGTON COUNTIES

	Rates	Fringes
CABLE SPLICER.....	\$ 32.74	22.38
ELECTRICIAN.....	\$ 32.49	22.38

ELEC1105-001 12/28/2015

COSHOCTON, GUERNSEY, KNOX (Jackson, Clay, Morgan, Miller, Milford, Hilliar, Butler, Harrison, Pleasant & College Townships), LICKING, MUSKINGUM, PERRY, and TUSCARAWAS (Auburn, York, Clay, Jefferson, Rush, Oxford, Washington, Salem, Perry & Bucks Townships) COUNTIES

	Rates	Fringes
ELECTRICIAN.....	\$ 30.20	15.08

ENGI0018-003 06/01/2016

ASHTABULA, CUYAHOGA, ERIE, GEAUGA, LAKE, LORAIN, MEDINA, PORTAGE, and SUMMIT COUNTIES

	Rates	Fringes
POWER EQUIPMENT OPERATOR		
GROUP 1.....	\$ 35.33	14.41
GROUP 2.....	\$ 35.23	14.41
GROUP 3.....	\$ 34.19	14.41
GROUP 4.....	\$ 32.97	14.41
GROUP 5.....	\$ 27.68	14.41
GROUP 6.....	\$ 35.58	14.41
GROUP 7.....	\$ 35.58	14.41

OPERATING ENGINEER CLASSIFICATIONS

GROUP 1 - Air Compressor on Steel Erection; Barrier Moving Machine; Boiler Operator on Compressor or Generator when mounted on a Rig; Cableway; Combination Concrete Mixer & Tower; Concrete Plant (over 4 yd. Capacity); Concrete Pump; Crane (All Types, Including Boom Truck, Cherry Picker); Crane-Compact, Track or Rubber over 4,000 lbs. capacity; Cranes-Self Erecting, Stationary, Track or Truck (All Configurations); Derrick; Dragline; Dredge (Dipper, Clam or Suction); Elevating Grader or Euclid Loader; Floating Equipment (All Types); Gradall; Helicopter Crew (Operator-Hoist or Winch); Hoe (all types); Hoisting Engine on Shaft or Tunnel Work; Hydraulic Gantry (Lifting System); Industrial-Type Tractor; Jet Engine Dryer (D8 or D9) Diesel

Tractor; Locomotive (Standard Gauge); Maintenance Operator Class A; Mixer, Paving (Single or Double Drum); Mucking Machine; Multiple Scraper; Piledriving Machine (All Types); Power Shovel; Prentice Loader; Quad 9 (Double Pusher); Rail Tamper (with auto lifting & aligning device); Refrigerating Machine (Freezer Operation); Rotary Drill, on Caisson work; Rough Terrain Fork Lift with Winch/Hoist; Side-Boom; Slip-Form Paver; Tower Derrick; Tree Shredder; Trench Machine (Over 24" wide); Truck Mounted Concrete Pump; Tug Boat; Tunnel Machine and/or Mining Machine; Wheel Excavator; and Asphalt Plant Engineer (Cleveland District Only).

GROUP 2 - Asphalt Paver; Automatic Subgrader Machine, Self-Propelled (CMI Type); Bobcat Type and/or Skid Steer Loader with Hoe Attachment Greater than 7,000 lbs.; Boring Machine More than 48"; Bulldozer; Endloader; Horizontal Directional Drill (Over 50,000 ft lbs thrust); Hydro Milling Machine; Kolman-type Loader (production type-Dirt); Lead Greaseman; Lighting & Traffic Signal Installation Equipment (includes all groups or classifications); Material Transfer Equipment (Shuttle Buggy) Asphalt; Pettibone-Rail Equipment; Power Grader; Power Scraper; Push Cat; Rotomill (all), Grinders & Planers of All types; Trench Machine (24" wide & under); Vermeer type Concrete Saw; and Maintenance Operators (Portage and Summit Counties Only).

GROUP 3 - A-Frame; Air Compressor on Tunnel Work (low pressure); Asphalt Plant Engineer (Portage and Summit Counties Only); Bobcat-type and/or Skid Steer Loader with or without Attachments; Highway Drills (all types); Locomotive (narrow gauge); Material Hoist/Elevator; Mixer, Concrete (more than one bag capacity); Mixer, one bag capacity (Side Loader); Power Boiler (Over 15 lbs. Pressure) Pump Operator installing & operating Well Points; Pump (4" & over discharge); Roller, Asphalt; Rotovator (lime soil stabilizer); Switch & Tie Tampers (without lifting & aligning device); Utility Operator (Small equipment); Welding Machines; and Railroad Tie Inserter/Remover; Articulating/straight bed end dumps if assigned (minus \$4.00 per hour).

GROUP 4 - Backfiller; Ballast Re-locator; Bars, Joint & Mesh Installing Machine; Batch Plant; Boring Machine Operator (48" or less); Bull Floats; Burlap & Curing Machine; Concrete Plant (capacity 4 yd. & under); Concrete Saw (Multiple); Conveyor (Highway); Crusher; Deckhand; Farm-type Tractor with attachments (highway); Finishing Machine; Fireperson, Floating Equipment (all types); Forklift; Form Trencher; Hydro Hammer expect masonry; Hydro Seeder; Pavement Breaker; Plant Mixer; Post Driver; Post Hole Digger (Power Auger); Power Brush Burner; Power Form Handling Equipment; Road Widening Trencher; Roller (Brick, Grade & Macadam); Self-Propelled Power Spreader; Self-Propelled Power Subgrader; Steam Fireperson; Tractor (Pulling Sheepfoot, Roller or Grader); and Vibratory

Compactor with Integral Power.

GROUP 5 - Compressor (Portable, Sewer, Heavy & Highway); Drum Fireperson (Asphalt Plant); Generator; Masonry Fork Lift; Inboard-Outboard Motor Boat Launch; Oil Heater (asphalt plant); Oiler/Helper; Power Driven Heater; Power Sweeper & Scrubber; Pump (under 4" discharge); Signalperson; Tire Repairperson; VAC/ALLS; Cranes - Compact, track or rubber under 4,000 pound capacity; fueling and greasing; and Chainmen.

GROUP 6 - Master Mechanic & Boom from 150 to 180.

GROUP 7 - Boom from 180 and over.

ENGI0018-004 06/01/2016

ADAMS, ALLEN, ASHLAND, ATHENS, AUGLAIZE, BELMONT, BROWN, BUTLER, CARROLL, CHAMPAIGN, CLARK, CLERMONT, CLINTON, COSHOCTON, CRAWFORD, DARKE, DEFIANCE, DELAWARE, FAIRFIELD, FAYETTE, FRANKLIN, FULTON, GALLIA, GREENE, GUERNSEY, HAMILTON, HANCOCK, HARDIN, HARRISON, HENRY, HIGHLAND, HOCKING, HOLMES, HURON, JACKSON, JEFFERSON, KNOX, LAWRENCE, LICKING, LOGAN, LUCAS, MADISON, MARION, MEIGS, MERCER, MIAMI, MONROE, MONTGOMERY, MORGAN, MORROW, MUSKINGUM, NOBLE, OTTAWA, PAULDING, PERRY, PICKAWAY, PIKE, PREBLE, PUTNAM, RICHLAND, ROSS, SANDUSKY, SCIOTO, SENECA, SHELBY, STARK, TUSCARAWAS, UNION, VAN WERT, VINTON, WARREN, WASHINGTON, WAYNE, WILLIAMS, WOOD, and YANDOT COUNTIES

	Rates	Fringes
POWER EQUIPMENT OPERATOR		
GROUP 1.....	\$ 33.84	14.41
GROUP 2.....	\$ 33.72	14.41
GROUP 3.....	\$ 32.68	14.41
GROUP 4.....	\$ 31.50	14.41
GROUP 5.....	\$ 26.04	14.41
GROUP 6.....	\$ 34.09	14.41
GROUP 7.....	\$ 34.09	14.41

OPERATING ENGINEER CLASSIFICATIONS

GROUP 1 - Air Compressor on Steel Erection; Barrier Moving Machine; Boiler Operator on Compressor or Generator when mounted on a Rig; Cableway; Combination Concrete Mixer & Tower; Concrete Plant (over 4 yd. Capacity); Concrete Pump; Crane (All Types, Including Boom Truck, Cherry Picker); Crane-Compact, Track or Rubber over 4,000 lbs. capacity; Cranes-Self Erecting, Stationary, Track or Truck (All Configurations); Derrick; Dragline; Dredge (Dipper, Clam or Suction); Elevating Grader or Euclid Loader; Floating Equipment (All Types); Gradall; Helicopter Crew (Operator-Hoist or Winch); Hoe (all types); Hoisting Engine on Shaft or Tunnel Work; Hydraulic Gantry (Lifting System); Industrial-Type Tractor; Jet Engine Dryer (D8 or D9) Diesel Tractor; Locomotive (Standard Gauge); Maintenance Operator Class A; Mixer, Paving (Single or Double Drum); Mucking Machine; Multiple Scraper;

Piledriving Machine (All Types); Power Shovel; Prentice Loader; Quad 9 (Double Pusher); Rail Tamper (with auto lifting & aligning device); Refrigerating Machine (Freezer Operation); Rotary Drill, on Caisson work; Rough Terrain Fork Lift with Winch/Hoist; Side-Boom; Slip-Form Paver; Tower Derrick; Tree Shredder; Trench Machine (Over 24" wide); Truck Mounted Concrete Pump; Tug Boat; Tunnel Machine and/or Mining Machine; and Wheel Excavator.

GROUP 2 - Asphalt Paver; Automatic Subgrader Machine, Self-Propelled (CMI Type); Bobcat Type and/or Skid Steer Loader with Hoe Attachment Greater than 7,000 lbs.; Boring Machine More than 48"; Bulldozer; Endloader; Hydro Milling Machine; Horizontal Directional Drill (over 50,000 ft. lbs. thrust); Kolman-type Loader (production type-Dirt); Lead Greaseman; Lighting & Traffic Signal Installation Equipment (includes all groups or classifications); Material Transfer Equipment (Shuttle Buggy) Asphalt; Pettibone-Rail Equipment; Power Grader; Power Scraper; Push Cat; Rotomill (all), Grinders & Planers of All types; Trench Machine (24" wide & under); and Vermeer type Concrete Saw.

GROUP 3 - A-Frame; Air Compressor on Tunnel Work (low pressure); Asphalt Plant Engineer; Bobcat-type and/or Skid Steer Loader with or without Attachments; Highway Drills (all types); Locomotive (narrow gauge); Material Hoist/Elevator; Mixer, Concrete (more than one bag capacity); Mixer, one bag capacity (Side Loader); Power Boiler (Over 15 lbs. Pressure. Pump Operator installing & operating Well Points; Pump (4" & over discharge); Railroad Tie Inserter/Remover; Roller, Asphalt; Rotovator (lime soil stabilizer); Switch & Tie Tampers (without lifting & aligning device); Utility Operator (Small equipment); and Welding Machines; Articulating/straight bed end dumps if assigned (minus \$4.00 per hour.

GROUP 4 - Backfiller; Ballast Re-locator; Bars, Joint & Mesh Installing Machine; Batch Plant; Boring Machine Operator (48" or less); Bull Floats; Burlap & Curing Machine; Concrete Plant (capacity 4 yd. & under); Concrete Saw (Multiple); Conveyor (Highway); Crusher; Deckhand; Farm-type Tractor with attachments (highway); Finishing Machine; Fireperson, Floating Equipment (all types); Fork Lift; Form Trencher; Hydro Hammer expect masonry; Hydro Seeder; Pavement Breaker; Plant Mixer; Post Driver; Post Hole Digger (Power Auger); Power Brush Burner; Power Form Handling Equipment; Road Widening Trencher; Roller (Brick, Grade & Macadam); Self-Propelled Power Spreader; Self-Propelled Power Subgrader; Steam Fireperson; Tractor (Pulling Sheepfoot, Roller or Grader); and Vibratory Compactor with Integral Power.

GROUP 5 - Compressor (Portable, Sewer, Heavy & Highway); Drum Fireperson (Asphalt Plant); Generator; Masonary Forklift; Inboard-Outboard Motor Boat Launch; Oil Heater (asphalt plant); Oiler/Helper; Power Driven Heater; Power Sweeper & Scrubber; Pump (under 4" discharge); Signalperson; Tire

Repairperson; VAC/ALLS; Cranes - Compact, track or rubber under 4,000 pound capacity; fueling and greasing; and Chainmen.

GROUP 6 - Master Mechanic & Boom from 150 to 180.

GROUP 7 - Boom from 180 and over.

 ENGI0066-023 06/01/2014

COLUMBIANA, MAHONING & TRUMBULL COUNTIES

	Rates	Fringes
POWER EQUIPMENT OPERATOR		
ASBESTOS; HAZARDOUS/TOXIC WASTE PROJECTS		
GROUP 1 - A & B.....	\$ 37.55	17.51
ASBESTOS; HAZARDOUS/TOXIC WASTE PROJECTS		
GROUP 2 - A & B.....	\$ 37.22	17.51
ASBESTOS; HAZARDOUS/TOXIC WASTE PROJECTS		
GROUP 3 - A & B.....	\$ 33.49	17.51
ASBESTOS; HAZARDOUS/TOXIC WASTE PROJECTS		
GROUP 4 - A & B.....	\$ 29.54	17.51
ASBESTOS; HAZARDOUS/TOXIC WASTE PROJECTS		
GROUP 5 - A & B.....	\$ 26.15	17.51
HAZARDOUS/TOXIC WASTE PROJECTS		
GROUP 1 - C & D.....	\$ 34.42	17.51
HAZARDOUS/TOXIC WASTE PROJECTS		
GROUP 2 - C & D.....	\$ 34.12	17.51
HAZARDOUS/TOXIC WASTE PROJECTS		
GROUP 3 - C & D.....	\$ 30.70	17.51
HAZARDOUS/TOXIC WASTE PROJECTS		
GROUP 4 - C & D.....	\$ 27.08	17.51
HAZARDOUS/TOXIC WASTE PROJECTS		
GROUP 5 - C & D.....	\$ 23.97	17.51
ALL OTHER WORK		
GROUP 1.....	\$ 31.29	17.51

ALL OTHER WORK

GROUP 2.....\$ 31.02	17.51
ALL OTHER WORK	
GROUP 3.....\$ 27.91	17.51
ALL OTHER WORK	
GROUP 4.....\$ 24.62	17.51
ALL OTHER WORK	
GROUP 5.....\$ 21.79	17.51

GROUP 1 - Rig, Pile Driver or Caisson Type; & Rig, Pile Hydraulic Unit Attached

GROUP 2 - Asphalt Heater Planer; Backfiller with Drag Attachment; Backhoe; Backhoe with Shear attached; Backhoe-Rear Pivotal Swing; Batch Plant-Central Mix Concrete; Batch Plant, Portable concrete; Berm Builder-Automatic; Boat Derrick; Boat-Tug; Boring Machine Attached to Tractor; Bullclam; Bulldozer; C.M.I. Road Builder & Similar Type; Cable Placer & Layer; Carrier-Straddle; Carryall-Scraper or Scoop; Chicago Boom; Compactor with Blade Attached; Concrete Saw (Vermeer or similar type); Concrete Spreader Finisher; Combination, Bidwell Machine; Crane; Crane-Electric Overhead; Crane-Rough Terrain; Crane-Side Boom; Crane-Truck; Crane-Tower; Derrick-Boom; Derrick-Car; Digger-Wheel (Not trencher or road widener); Double Nine; Drag Line; Dredge; Drill-Kenny or Similar Type; Easy Pour Median Barrier Machine (or similar type); Electromatic; Frankie Pile; Gradall; Grader; Gurry; Self-Propelled; Heavy Equipment Robotics Operator/Mechanic; Hoist-Monorail; Hoist-Stationary & Mobile Tractor; Hoist, 2 or 3 drum; Horizontal Directional Drill Operator; Jackall; Jumbo Machine; Kocal & Kuhlman; Land-Seagoing Vehicle; Loader, Elevating; Loader, Front End; Loader, Skid Steer; Locomotive; Mechanic/Welder; Metro Chip Harvester with Boom; Mucking Machine; Paver-Asphalt Finishing Machine; Paver-Road Concrete; Paver-Slip Form (C.M.I. or similar); Place Crete Machine with Boom; Post Driver (Carrier mounted); Power Driven Hydraulic Pump & Jack (When used in Slip Form or Lift Slab Construction); Pump Crete Machine; Regulator-Ballast; Hydraulic Power Unit not attached to Rig for Pile Drillings; Rigs-Drilling; Roto Mill or similar Full Lane (8' Wide & Over); Roto Mill or similar type (Under 8'); Shovel; Slip Form Curb Machine; Speedwing; Spikemaster; Stonecrusher; Tie Puller & Loader; Tie Tamper; Tractor-Double Boom; Tractor with Attachments; Truck-Boom; Truck-Tire; Trench Machine; Tunnel Machine (Mark 21 Java or similar); & Whirley (or similar type)

GROUP 3 - Asphalt Plant; Bending Machine (Pipeline or similar type); Boring machine, Motor Driven; Chip Harvester without Boom; Cleaning Machine, Pipeline Type; Coating Machine, Pipeline Type; Compactor; Concrete Belt Placer;

Concrete Finisher; Concrete Planer or Asphalt; Concrete Spreader; Elevator; Fork Lift (Home building only); Fork lift & Lulls; Fork Lift Walk Behind (Hoisting over 1 buck high); Form Line Machine; Grease Truck operator; Grout Pump; Gunnite Machine; Horizontal Directional Drill Locator; Single Drum Hoist with or without Tower; Huck Bolting Machine; Hydraulic Scaffold (Hoisting building materials); Paving Breaker (Self-propelled or Ridden); Pipe Dream; Pot Fireperson (Power Agitated); Refrigeration Plant; Road Widener; Roller; Sasgen Derrick; Seeding Machine; Soil Stabilizer (Pump type); Spray Cure Machine, Self-Propelled; Straw Blower Machine; Sub-Grader; Tube Finisher or Broom C.M.I. or similar type; & Tugger Hoist

GROUP 4 - Air Curtain Destructor & Similar Type; Batch Plant-Job Related; Boiler Operator; Compressor; Conveyor; Curb Builder, self-propelled; Drill Wagon; Generator Set; Generator-Steam; Heater-Portable Power; Hydraulic Manipulator Crane; Jack-Hydraulic Power driven; Jack-Hydraulic (Railroad); Ladavator; Minor Machine Operator; Mixer-Concrete; Mulching Machine; Pin Puller; Power Broom; Pulverizer; Pump; Road Finishing Machine (Pull Type); Saw-Concrete-Self-Propelled (Highway Work); Signal Person; Spray Cure Machine-Motor Powered; Stump Cutter; Tractor; Trencher Form; Water Blaster; Steam Jenny; Syphon; Vibrator-Gasoline; & Welding Machine

GROUP 5 - Brakeperson; Fireperson; & Oiler

IRON0017-002 05/01/2016

ASHTABULA (North of Route 6, starting at the Geauga County Line, proceeding east to State Route 45), CUYAHOGA, ERIE (Eastern 2/3), GEAUGA, HURON (East of a line drawn from the north border through Monroeville & Willard), LAKE, LORAIN, MEDINA (North of Old Rte. #224), PORTAGE (West of a line from Middlefield to Shalersville to Deerfield), and SUMMIT (North of Old Rte. #224, including city limits of Barberton) COUNTIES

	Rates	Fringes
IRONWORKER		
Ornamental, Reinforcing, & Structural.....	\$ 33.33	20.55

IRON0017-010 05/01/2016

ASHTABULA (Eastern part from Lake Erie on the north to route #322 on the south to include Conneaut, Kingsville, Sheffield, Denmark, Dorset, Cherry Valley, Wayne, Monroe, Pierpont, Richmond, Andover & Williamsfield Townships)

	Rates	Fringes
IRONWORKER		
Structural, including metal building erection & Reinforcing.....	\$ 33.33	20.55

IRON0044-002 06/01/2016

CLINTON (South of a line drawn from Blanchester to Lynchburg), HAMILTON, HIGHLAND (Excluding eastern one-fifth & portion of county inside lines drawn from Marshall to Lynchburg from the northern county line through E. Monroe to Marshall) & WARREN (South of a line drawn from Blanchester through Morrow to the west county line)

	Rates	Fringes
IRONWORKER		
Fence Erector.....	\$ 25.15	20.20
Ornamental; Structural.....	\$ 26.47	20.20

IRON0055-003 07/01/2015

CRAWFORD (Area Between lines drawn from where Hwy #598 & #30 meet through N. Liberty to the northern border & from said Hwy junction point due west to the border), DEFIANCE (S. of a line drawn from where Rte. #66 meets the northern line through Independence to the eastern county border), ERIE (Western 1/3), FULTON, HANCOCK, HARDIN (North of a line drawn from Maysville to a point 4 miles south of the northern line on the eastern line), HENRY, HURON (West of a line drawn from the northern border through Monroeville & Willard), LUCAS, OTTAWA, PUTNAM (East of a line drawn from the northern border down through Miller City to where #696 meets the southern border), SANDUSKY, SENECA, WILLIAMS (East of a line drawn from Pioneer through Stryker to the southern border), WOOD & WYANDOT (North of Rte. #30)

	Rates	Fringes
IRONWORKER		
Fence Erector.....	\$ 20.00	20.13
Flat Road Mesh.....	\$ 20.75	18.00
Tunnels & Caissons Under Pressure.....	\$ 28.50	18.00
All Other Work.....	\$ 29.12	21.47

IRON0147-002 06/01/2015

ALLEN (Northern half), DEFIANCE (Northern part, excluding south of a line drawn from where Rte. #66 meets the northern line through Independence to the eastern county border), MERCER (Northern half), PAULDING, PUTNAM (Western part, excluding east of a line drawn from the northern border down through Miller City to where #696 meets the southern border), VAN WERT, and WILLIAMS (Western part, excluding east of a line drawn from Pioneer through Stryker to the southern border) COUNTIES

	Rates	Fringes
IRONWORKER.....	\$ 25.39	20.64

IRON0172-002 06/01/2016

CHAMPAIGN (Eastern one-third), CLARK (Eastern one-fourth), COSHOCTON (West of a line beginning at the northwestern county line going through Walhonding & Tunnel Hill to the southern

county line), CRAWFORD (South of Rte. #30), DELAWARE, FAIRFIELD, FAYETTE, FRANKLIN, HARDIN (Excluding a line drawn from Roundhead to Maysville), HIGHLAND (Eastern one-fifth), HOCKING, JACKSON (Northern half), KNOX, LICKING, LOGAN (Eastern one-third), MADISON, MARION, MORROW, MUSKINGUM (West of a line starting at Adams Mill going to Adamsville & going from Adamsville through Blue Rock to the southern border), PERRY, PICKAWAY, PIKE (Northern half), ROSS, UNION, VINTON and WYANDOT (South of Rte. #30) COUNTIES

	Rates	Fringes
IRONWORKER.....	\$ 28.12	19.94

IRON0207-004 06/01/2015

ASHTABULA (Southern part starting at the Geauga County line), COLUMBIANA (E. of a line from Damascus to Highlandtown), MAHONING (N. of Old Route #224), PORTAGE (E. of a line from Middlefield to Shalersville to Deerfield) & TRUMBULL

	Rates	Fringes
IRONWORKER		
Layout; Sheeter.....	\$ 29.06	22.70
Ornamental; Reinforcing;		
Structural.....	\$ 28.06	22.70

IRON0290-002 06/01/2016

ALLEN (Southern half), AUGLAIZE, BUTLER (North of a line drawn from east to the west county line going through Oxford, Darrrtown & Woodsdale), CHAMPAIGN (Excluding east of a line drawn from Catawla to the point where #68 intersects the northern county line), CLARK (Western two-thirds), CLINTON (Excluding south of a line drawn from Blanchester to Lynchburg), DARKE, GREENE, HIGHLAND (Inside lines drawn from Marshall to Lynchburg & from the northern county line through East Monroe to Marshall), LOGAN (West of a line drawn from West Liberty to where the northern county line meets the western county line of Hardin), MERCER (Southern half), MIAMI, MONTGOMERY, PREBLE, SHELBY & WARREN (Excluding south of a line drawn from Blanchester through Morrow to the western county line) COUNTIES

	Rates	Fringes
IRONWORKER.....	\$ 27.00	20.93

IRON0372-002 07/01/2016

ADAMS (Western Part), BROWN, BUTLER (Southern Part), CLERMONT, CLINTON (South of a line drawn from Blanchester to Lynchburg), HAMILTON, HIGHLAND (Excluding eastern one-fifth & portion of county inside lines drawn from Marshall to Lynchburg from the northern county line through E. Monroe to Marshall) and WARREN (South of a line drawn from Blanchester through Morrow to the west county line) COUNTIES

	Rates	Fringes
IRONWORKER, REINFORCING		
Beyond 30-mile radius of		

Hamilton County Courthouse..\$ 27.40	20.15
Up to & including 30-mile radius of Hamilton County Courthouse.....\$ 27.15	20.15

IRON0549-003 12/01/2015

BELMONT, GUERNSEY, HARRISON, JEFFERSON, MONROE & MUSKINGUM
(Excluding portion west of a line starting at Adams Mill going
to Adamsville and going from Adamsville through Blue Rock to
the south border)

	Rates	Fringes
IRONWORKER.....\$ 32.74		17.84

IRON0550-004 05/01/2015

ASHLAND, CARROLL, COLUMBIANA (W. of a line from Damascus to
Highlandtown), COSHOCTON (E. of a line beginning at NW Co. line
going through Walhonding & Tunnel Hill to the South Co. line),
HOLMES, HURON (S. of Old Rte. #224), MAHONING (S. of Old Rte.
#224), MEDINA (S. of Old Rte. #224), PORTAGE (S. of Old Rte.
#224), RICHLAND, STARK, SUMMIT (S. of Old Rte. #224, Excluding
city limits of Barberton), TUSCARAWAS, & WAYNE

	Rates	Fringes
Ironworkers:Structural, Ornamental and Reinforcing.....\$ 26.66		18.36

IRON0769-004 06/01/2016

ADAMS (Eastern Half), GALLIA, JACKSON (Southern Half), LAWRENCE
& SCIOTO

	Rates	Fringes
IRONWORKER.....\$ 31.33		23.47

IRON0787-003 06/01/2015

ATHENS, MEIGS, MORGAN, NOBLE, and WASHINGTON COUNTIES

	Rates	Fringes
IRONWORKER.....\$ 30.28		20.15

LABO0265-008 05/01/2014

	Rates	Fringes
LABORER		
ASHTABULA, ERIE, HURON, LORAIN, LUCAS, MAHONING, MEDINA, OTTAWA, PORTAGE, SANDUSKY, STARK, SUMMIT, TRUMBULL & WOOD COUNTIES		
GROUP 1.....\$ 28.15		9.80
GROUP 2.....\$ 28.32		9.80
GROUP 3.....\$ 28.65		9.80
GROUP 4.....\$ 29.10		9.80
CUYAHOGA AND GEAUGA		

COUNTIES ONLY: SEWAGE PLANTS, WASTE PLANTS, WATER TREATMENT FACILITIES, PUMPING STATIONS, & ETHANOL PLANTS		
CONSTRUCTION.....	\$ 30.76	9.80
CUYAHOGA, GEAUGA & LAKE COUNTIES		
GROUP 1.....	\$ 29.38	9.80
GROUP 2.....	\$ 29.55	9.80
GROUP 3.....	\$ 29.88	9.80
GROUP 4.....	\$ 30.33	9.80
REMAINING COUNTIES OF OHIO		
GROUP 1.....	\$ 27.72	9.80
GROUP 2.....	\$ 27.89	9.80
GROUP 3.....	\$ 28.22	9.80
GROUP 4.....	\$ 28.67	9.80

LABORER CLASSIFICATIONS

GROUP 1 - Asphalt Laborer; Carpenter Tender; Concrete Curing Applicator; Dump Man (Batch Truck); Guardrail and Fence Installer; Joint Setter; Laborer (Construction); Landscape Laborer; Mesh Handlers & Placer; Right-of-way Laborer; Riprap Laborer & Grouter; Scaffold Erector; Seal Coating; Surface Treatment or Road Mix Laborer; Sign Installer; Slurry Seal; Utility Man; Bridge Man; Handyman; Waterproofing Laborer; Flagperson; Hazardous Waste (level D); Diver Tender; Zone Person & Traffic Control

GROUP 2 - Asphalt Raker; Concrete Puddler; Kettle Man (Pipeline); Machine Driven Tools (Gas, Electric, Air); Mason Tender; Brick Paver; Mortar Mixer; Power Buggy or Power Wheelbarrow; Sheeting & Shoring Man; Surface Grinder Man; Plastic Fusing Machine Operator; Pug Mill Operator; & Vacuum Devices (wet or dry); Rodding Machine Operator; Diver; Screwman or Paver; Screed Person; Water Blast, Hand Held Wand; Pumps 4" & Under (Gas, Air or Electric) & Hazardous Waste (level C); Air Track and Wagon Drill; Bottom Person; Cofferdam (below 25 ft. deep); Concrete Saw Person; Cutting with Burning Torch; Form Setter; Hand Spiker (Railroad); Pipelayer; Tunnel Laborer (without air) & Caisson; Underground Person (working in Sewer and Waterline, Cleaning, Repairing & Reconditioning); Sandblaster Nozzle Person; & Hazardous Waste (level B)

GROUP 3 - Blaster; Mucker; Powder Person; Top Lander; Wrencher (Mechanical Joints & Utility Pipeline); Yarner; Hazardous Waste (level A); Concrete Specialist; Concrete Crew in Tunnels (With Air-pressurized - \$1.00 premium); Curb Setter & Cutter; Grade Checker; Utility Pipeline Tapper; Waterline; and Caulker

GROUP 4 - Miner (With Air-pressurized - \$1.00 premium); & Gunite Nozzle Person

TUNNEL LABORER WITH AIR-PRESSURIZED ADD \$1.00 TO BASE RATE

SIGNAL PERSON WILL RECEIVE THE RATE EQUAL TO THE RATE PAID
 THE LABORER CLASSIFICATION FOR WHICH HE OR SHE IS SIGNALING.

 PAIN0006-002 05/01/2016

ASHTABULA, CUYAHOGA, GEAUGA, LAKE, LORAIN, PORTAGE (N. of the
 East-West Turnpike) & SUMMIT (N. of the East-West Turnpike)

	Rates	Fringes
PAINTER		
COMMERCIAL NEW WORK; REMODELING; & RENOVATIONS		
GROUP 1.....	\$ 27.77	14.21
GROUP 2.....	\$ 28.17	14.21
GROUP 3.....	\$ 28.47	14.21
GROUP 4.....	\$ 29.47	14.21
COMMERCIAL REPAINT		
GROUP 1.....	\$ 26.27	14.21
GROUP 2.....	\$ 26.67	14.21
GROUP 3.....	\$ 26.97	14.21

PAINTER CLASSIFICATIONS - COMMERCIAL NEW WORK; REMODELING; &
 RENOVATIONS

GROUP 1 - Brush; & Roller

GROUP 2 - Sandblasting & Buffing

GROUP 3 - Spray Painting; Closed Steel Above 55 feet; Bridges
 & Open Structural Steel; Tanks - Water Towers; Bridge
 Painters; Bridge Riggers; Containment Builders

GROUP 4 - Bridge Blaster

PAINTER CLASSIFICATIONS - COMMERCIAL REPAINT

GROUP 1 - Brush; & Roller

GROUP 2 - Sandblasting & Buffing

GROUP 3 - Spray Painting

 PAIN0007-002 07/01/2016

FULTON, HENRY, LUCAS, OTTAWA (Excluding Allen, Bay, Bono,
 Catawba Island, Clay Center, Curtice, Danbury, Eagle Beach,
 Elliston, Elmore, Erie, Fishback, Gem Beach & Genova) & WOOD

	Rates	Fringes
PAINTER		
NEW COMMERCIAL WORK		
GROUP 1.....	\$ 25.22	15.21
GROUP 2.....	\$ 25.47	15.21
GROUP 3.....	\$ 25.72	15.21
GROUP 4.....	\$ 25.82	15.21
GROUP 5.....	\$ 25.92	15.21
GROUP 6.....	\$ 26.22	15.21
GROUP 7.....	\$ 26.22	15.21

GROUP 8.....	\$ 26.52	15.21
GROUP 9.....	\$ 26.97	15.21

REPAINT IS 90% OF JR

PAINTER CLASSIFICATIONS

GROUP 1 - Brush; Spray & Sandblasting Pot Tender

GROUP 2 - Refineries & Refinery Tanks; Surfaces 30 ft. or over where material is applied to or labor performed on above ground level (exterior), floor level (interior)

GROUP 3 - Swing Stage & Chair

GROUP 4 - Lead Abatement

GROUP 5 - All Methods of Spray

GROUP 6 - Solvent-Based Catalized Epoxy Materials of 2 or More Component Materials, to include Solvent-Based Conversion Varnish (excluding water based)

GROUP 7 - Spray Solvent Based Material; Sand & Abrasive Blasting

GROUP 8 - Towers; Tanks; Bridges; Stacks Over 30 Feet

GROUP 9 - Epoxy Spray (excluding water based)

PAIN0012-008 05/01/2015

BUTLER COUNTY

	Rates	Fringes
PAINTER		
GROUP 1.....	\$ 20.73	9.11
GROUP 2.....	\$ 23.39	9.11
GROUP 3.....	\$ 23.89	9.11
GROUP 4.....	\$ 24.14	9.11
GROUP 5.....	\$ 24.39	9.11

PAINTER CLASSIFICATIONS

GROUP 1: Bridge Equipment Tender; Bridge/Containment Builder

GROUP 2: Brush & Roller

GROUP 3: Spray

GROUP 4: Sandblasting; & Waterblasting

GROUP 5: Elevated Tanks; Steeplejack Work; Bridge; & Lead Abatement

PAIN0012-010 05/01/2015

BROWN, CLERMONT, CLINTON, HAMILTON & WARREN

	Rates	Fringes
PAINTER		
HEAVY & HIGHWAY BRIDGES-		
GUARDRAILS-LIGHTPOLES-		
STRIPING		
Bridge Equipment Tender and Containment Builder....	\$ 20.73	9.11
Bridges when highest point of clearance is 60 feet or more; & Lead Abatement Projects.....	\$ 24.39	9.11
Brush & Roller.....	\$ 23.39	9.11
Sandblasting & Hopper Tender; Water Blasting.....	\$ 24.14	9.11
Spray.....	\$ 23.89	9.11

PAIN0093-001 12/01/2015

ATHENS, GUERNSEY, HOCKING, MONROE, MORGAN, NOBLE and
WASHINGTON COUNTIES

	Rates	Fringes
PAINTER		
Bridges; Locks; Dams; Tension Towers; & Energized Substations.....	\$ 30.69	16.15
Power Generating Facilities.	\$ 27.54	16.15

PAIN0249-002 05/01/2016

CLARK, DARKE, GREENE, MIAMI, MONTGOMERY & PREBLE

	Rates	Fringes
PAINTER		
GROUP 1 - Brush & Roller....	\$ 23.29	9.40
GROUP 2 - Swing, Scaffold Bridges; Structural Steel; Open Acid Tank; High Tension Electrical Equipment; & Hot Pipes.....	\$ 23.29	9.40
GROUP 3 - Spray; Sandblast; Steamclean; Lead Abatement.....	\$ 24.04	9.40
GROUP 4 - Steeplejack Work..	\$ 24.24	9.40
GROUP 5 - Coal Tar.....	\$ 24.79	9.40
GROUP 6 - Bridge Equipment Tender & or Containment Builder.....	\$ 26.53	9.40
GROUP 7 - Tanks, Stacks & Towers.....	\$ 26.93	9.40
GROUP 8 - Bridge Blaster, Rigger.....	\$ 32.90	9.40

PAIN0356-002 09/01/2009

KNOX, LICKING, MUSKINGUM, and PERRY

	Rates	Fringes
PAINTER		
Bridge Equipment Tenders and Containment Builders....	\$ 27.93	7.25
Bridges; Blasters; and Riggers.....	\$ 34.60	7.25
Brush and Roller.....	\$ 20.93	7.25
Sandblasting; Steam Cleaning; Waterblasting; and Hazardous Work.....	\$ 25.82	7.25
Spray.....	\$ 21.40	7.25
Structural Steel and Swing Stage.....	\$ 25.42	7.25
Tanks; Stacks; and Towers...	\$ 28.63	7.25

PAIN0438-002 12/01/2015

BELMONT, HARRISON and JEFFERSON COUNTIES

	Rates	Fringes
PAINTER		
Bridges, Locks, Dams, Tension Towers & Energized Substations.....	\$ 31.88	14.90
Power Generating Facilities.	\$ 28.73	14.90

PAIN0476-001 06/01/2016

COLUMBIANA, MAHONING, and TRUMBULL COUNTIES

	Rates	Fringes
PAINTER		
GROUP 1.....	\$ 25.37	11.93
GROUP 2.....	\$ 27.37	11.93
GROUP 3.....	\$ 25.58	11.93
GROUP 4.....	\$ 25.87	11.93
GROUP 5.....	\$ 26.02	11.93
GROUP 6.....	\$ 26.27	11.93
GROUP 7.....	\$ 27.37	11.93

PAINTER CLASSIFICATIONS:

GROUP 1: Painters, Brush & Roller

GROUP 2: Bridges

GROUP 3: Structural Steel

GROUP 4: Spray, Except Bar Joist/Deck

GROUP 5: Epoxy/Mastic; Spray- Bar Joist/Deck; Working Above
50 Feet; and Swingstages

GROUP 6: Tanks; Sandblasting

GROUP 7: Towers; Stacks

PAIN0555-002 06/01/2016

ADAMS, HIGHLAND, JACKSON, PIKE & SCIOTO

	Rates	Fringes
PAINTER		
GROUP 1.....	\$ 30.00	14.62
GROUP 2.....	\$ 31.38	14.62
GROUP 3.....	\$ 32.76	14.62
GROUP 4.....	\$ 35.45	14.62

PAINTER CLASSIFICATIONS

GROUP 1 - Containment Builder

GROUP 2 - Brush; Roller; Power Tools, Under 40 feet

GROUP 3 - Sand Blasting; Spray; Steam Cleaning; Pressure Washing; Epoxy & Two Component Materials; Lead Abatement; Hazardous Waste; Toxic Materials; Bulk & Storage Tanks of 25,000 Gallon Capacity or More; Elevated Tanks

GROUP 4 - Stacks; Bridges

PAIN0603-002 06/01/2012

CARROLL, COSHOCTON, HOLMES, STARK, TUSCARAWAS & WAYNE

	Rates	Fringes
PAINTER		
Bridges; Towers, Poles & Stacks; Sandblasting Steel; Structural Steel & Metalizing.....	\$ 20.71	11.00
Brush & Roller.....	\$ 20.00	11.00
Spray; Tank Interior & Exterior.....	\$ 20.53	11.00

PAIN0639-001 05/01/2011

	Rates	Fringes
Sign Painter & Erector.....	\$ 20.61	3.50+a+b+c

FOOTNOTES: a. 7 Paid Holidays: New Year's Day; Memorial Day; July 4th; Labor Day; Thanksgiving Day; Christmas Day & 1 Floating Day

b. Vacation Pay: After 1 year's service - 5 days' paid vacation; After 2, but less than 10 years' service - 10 days' paid vacation; After 10, but less than 20 years' service - 15 days' paid vacation; After 20 years' service - 20 days' paid vacation

c. Funeral leave up to 3 days maximum paid leave for death of mother, father, brother, sister, spouse, child, mother-in-law, father-in-law, grandparent and inlaw provided employee attends funeral

PAIN0788-002 06/01/2016

ASHLAND, CRAWFORD, ERIE, HANCOCK, HURON, MARION, MORROW, OTTAWA (Allen, Bay, Bono, Catawba Island, Clay Center, Curtice, Danbury, Eagle Beach, Elliston, Elmore, Erie, Fishback, Gem Beach & Genoa), RICHLAND, SANDUSKY, SENECA & WYANDOT

	Rates	Fringes
PAINTER		
Brush & Roller.....	\$ 23.52	12.07
Structural Steel.....	\$ 25.12	12.07

WINTER REPAINT: Between December 1 to March 31 - 90%JR

\$.50 PER HOUR SHALL BE ADDED TO THE RATE OF PAY FOR THE CLASSIFICATION OF WORK:

While working swingstage, boatswain chair, needle beam and horizontal cable. While operating sprayguns, sandblasting, cobblasting and high pressure waterblasting (4000psi).

\$1.00 PER HOUR SHALL BE ADDED TO THE RATE OF PAY FOR THE CLASSIFICATION OF WORK:

For the application of catalized epoxy, including latex epoxy that is deemed hazardous, lead abatement, or for work or material where special precautions beyond normal work duties must be taken. For working on stacks, tanks, and towers over 40 feet in height.

PAIN0813-005 12/01/2008

GALLIA, LAWRENCE, MEIGS & VINTON

	Rates	Fringes
PAINTER		
Base Rate.....	\$ 24.83	10.00
Bridges, Locks, Dams & Tension Towers.....	\$ 27.83	10.00

PAIN0841-001 06/01/2016

MEDINA, PORTAGE (South of and including Ohio Turnpike), and SUMMIT (South of and including Ohio Turnpike) COUNTIES

	Rates	Fringes
Painters:		
GROUP 1.....	\$ 25.08	13.22
GROUP 2.....	\$ 25.73	13.22
GROUP 3.....	\$ 25.83	13.22
GROUP 4.....	\$ 25.93	13.22
GROUP 5.....	\$ 26.33	13.22
GROUP 6.....	\$ 39.20	11.75
GROUP 7.....	\$ 26.33	13.22

PAINTER CLASSIFICATIONS:

GROUP 1 - Brush, Roller & Paperhanger

GROUP 2 - Epoxy Application

GROUP 3 - Swing Scaffold, Bosum Chair, & Window Jack

GROUP 4 - Spray Gun Operator of Any & All Coatings

GROUP 5 - Sandblast, Painting of Standpipes, etc. from Scaffolds, Bridge Work and/or Open Structural Steel, Standpipes and/or Water Towers

GROUP 6 - Public & Commerce Transportation, Steel or Galvanized, Bridges, Tunnels & Related Support Items (concrete)

GROUP 7 - Synthetic Exterior, Drywall Finisher and/or Taper, Drywall Finisher and Follow-up Man Using Automatic Tools

 PAIN1020-002 07/01/2016

ALLEN, AUGLAIZE, CHAMPAIGN, DEFIANCE, HARDIN, LOGAN, MERCER, PAULDING, PUTNAM, SHELBY, VAN WERT, and WILLIAMS COUNTIES

	Rates	Fringes
PAINTER		
Brush & Roller.....	\$ 23.58	11.97
Drywall Finishing & Taping..	\$ 22.28	11.97
Lead Abatement.....	\$ 25.33	11.97
Spray, Sandblasting Pressure Cleaning, & Refinery.....	\$ 24.33	11.97
Swing Stage, Chair, Spiders, & Cherry Pickers...	\$ 23.83	11.97
Wallcoverings.....	\$ 21.18	11.97

All surfaces 40 ft. or over where material is applied to or labor performed on, above ground level (exterior), floor level (interior) - \$.50 premium

Applying Coal Tar Products - \$1.00 premium

 PAIN1275-002 11/01/2015

DELAWARE, FAIRFIELD, FAYETTE, FRANKLIN, MADISON, PICKAWAY, ROSS & UNION

	Rates	Fringes
PAINTER		
Bridges.....	\$ 34.18	11.26
Brush; Roller.....	\$ 24.70	11.26
Sandblasting; Steamcleaning; Waterblasting (3500 PSI or Over)& Hazardous Work.....	\$ 25.40	11.26
Spray.....	\$ 25.20	11.26
Stacks; Tanks; & Towers.....	\$ 28.21	11.26
Structural Steel & Swing Stage.....	\$ 25.00	11.26

 PLUM0042-002 07/01/2016

ASHLAND, CRAWFORD, ERIE, HURON, KNOX, LORAIN, MORROW, RICHLAND & WYANDOT

	Rates	Fringes
Plumber, Pipefitter, Steamfitter.....	\$ 31.95	20.32

 PLUM0050-002 07/04/2016

DEFIANCE, FULTON, HANCOCK, HENRY, LUCAS, OTTAWA, PAULDING,
 PUTNAM, SANDUSKY, SENECA, WILLIAMS & WOOD

	Rates	Fringes
Plumber, Pipefitter, Steamfitter.....	\$ 40.00	24.36

 PLUM0055-003 05/02/2016

ASHTABULA, CUYAHOGA, GEAUGA, LAKE, MEDINA (N. of Rte. #18 &
 Smith Road) & SUMMIT (N. of Rte. #303, including the corporate
 limits of the city of Hudson)

	Rates	Fringes
PLUMBER.....	\$ 34.90	23.08

 PLUM0083-001 07/01/2013

BELMONT & MONROE (North of Rte. #78)

	Rates	Fringes
Plumber and Steamfitter.....	\$ 25.42	27.83

 PLUM0094-002 05/01/2016

CARROLL (Northen Half), STARK, and WAYNE COUNTIES

	Rates	Fringes
PLUMBER/PIPEFITTER.....	\$ 34.53	17.49

 PLUM0120-002 05/02/2016

ASHTABULA, CUYAHOGA, GEAUGA, LAKE, LORAIN (the C.E.I. Power
 House in Avon Lake), MEDINA (N. of Rte. #18) & SUMMIT (N. of
 #303)

	Rates	Fringes
PIPEFITTER.....	\$ 36.77	22.90

 PLUM0162-002 06/01/2016

CHAMPAIGN, CLARK, CLINTON, DARKE, FAYETTE, GREENE, MIAMI,
 MONTGOMERY & PREBLE

	Rates	Fringes
Plumber, Pipefitter, Steamfitter.....	\$ 28.80	20.92

 PLUM0168-002 06/01/2016

MEIGS, MONROE (South of Rte. #78), MORGAN (South of Rte. #78)
 & WASHINGTON

	Rates	Fringes
PLUMBER/PIPEFITTER.....	\$ 32.58	27.22

PLUM0189-002 06/01/2013		
DELAWARE, FAIRFIELD, FRANKLIN, HOCKING, LICKING, MADISON, MARION, PERRY, PICKAWAY, ROSS & UNION		
	Rates	Fringes
Plumber, Pipefitter, Steamfitter.....	\$ 34.08	20.06

* PLUM0219-002 06/01/2016		
MEDINA (Rte. #18 from eastern edge of Medina Co., west to eastern corporate limits of the city of Medina, & on the county road from the west corporate limits of Medina running due west to and through community of Risley to the western edge of Medina County - All territory south of this line), PORTAGE, and SUMMIT (S. of Rte. #303) COUNTIES		
	Rates	Fringes
Plumber and Steamfitter.....	\$ 36.27	23.24

PLUM0392-002 06/01/2016		
BROWN, BUTLER, CLERMONT, HAMILTON & WARREN		
	Rates	Fringes
PLUMBER/PIPEFITTER.....	\$ 31.39	18.77

PLUM0396-001 06/01/2016		
COLUMBIANA (Excluding Washington & Yellow Creek Townships & Liverpool Twp. - Secs. 35 & 36 - West of County Road #427), MAHONING and TRUMBULL COUNTIES		
	Rates	Fringes
PLUMBER/PIPEFITTER.....	\$ 33.50	21.96

PLUM0495-002 06/01/2016		
CARROLL (Rose, Monroe, Union, Lee, Orange, Perry & Loudon Townships), COLUMBIANA (Washington & Yellow Creek Townships & Liverpool Township, Secs. 35 & 36, West of County Rd. #427), COSHOCKTON, GUERNSEY, HARRISON, HOLMES, JEFFERSON, MORGAN (South to State Rte. #78 & from McConnelsville west on State Rte. #37 to the Perry County line), MUSKINGUM, NOBLE, and TUSCARAWAS COUNTIES		
	Rates	Fringes
Plumber, Pipefitter, Steamfitter.....	\$ 41.08	21.26

PLUM0577-002 06/01/2016		
ADAMS, ATHENS, GALLIA, HIGHLAND, JACKSON, LAWRENCE, PIKE, SCIOTO & VINTON		

	Rates	Fringes
Plumber, Pipefitter, Steamfitter.....	\$ 32.60	22.73

 * PLUM0776-002 07/01/2016

ALLEN, AUGLAIZE, HARDIN, LOGAN, MERCER, SHELBY and VAN WERT
 COUNTIES

	Rates	Fringes
Plumber, Pipefitter, Steamfitter.....	\$ 34.25	22.09

 TEAM0377-003 05/01/2012

STATEWIDE, EXCEPT CUYAHOGA, GEAUGA & LAKE

	Rates	Fringes
TRUCK DRIVER		
GROUP 1.....	\$ 23.38	13.18
GROUP 2.....	\$ 23.80	13.18

TRUCK DRIVER CLASSIFICATIONS

- GROUP 1 - Asphalt Distributor; Batch; 4- Wheel Service;
 4-Wheel Dump; Oil Distributor & Tandem

- GROUP 2 - Tractor-Trailer Combination: Fuel; Pole Trailer;
 Ready Mix; Semi-Tractor; & Asphalt Oil Spraybar Man When
 Operated From Cab; 5 Axles & Over; Belly Dump; End Dump;
 Articulated Dump; Heavy Duty Equipment; Low Boy; & Truck
 Mechanic

 TEAM0436-002 05/01/2015

CUYAHOGA, GEAUGA & LAKE

	Rates	Fringes
TRUCK DRIVER		
GROUP 1.....	\$ 26.90	14.85
GROUP 2.....	\$ 27.40	14.85

GROUP 1: Straight & Dump, Straight Fuel

- GROUP 2: Semi Fuel, Semi Tractor, Euclids, Darts, Tank,
 Asphalt Spreaders, Low Boys, Carry-All, Tourna-Rockers,
 Hi-Lifts, Extra Long Trailers, Semi-Pole Trailers, Double
 Hook-Up Tractor Trailers including Team Track & Railroad
 Siding, Semi-Tractor & Tri-Axle Trailer, Tandem Tractor &
 Tandem Trailer, Tag Along Trailer, Expandable Trailer or
 Towing Requiring Road Permits, Ready-Mix (Agitator or
 Non-Agitator), Bulk Concrete Driver, Dry Batch Truck,
 Articulated End Dump

 WELDERS - Receive rate prescribed for craft performing
 operation to which welding is incidental.
 =====

Unlisted classifications needed for work not included within the scope of the classifications listed may be added after award only as provided in the labor standards contract clauses (29CFR 5.5 (a) (1) (ii)).

The body of each wage determination lists the classification and wage rates that have been found to be prevailing for the cited type(s) of construction in the area covered by the wage determination. The classifications are listed in alphabetical order of "identifiers" that indicate whether the particular rate is a union rate (current union negotiated rate for local), a survey rate (weighted average rate) or a union average rate (weighted union average rate).

Union Rate Identifiers

A four letter classification abbreviation identifier enclosed in dotted lines beginning with characters other than "SU" or "UAVG" denotes that the union classification and rate were prevailing for that classification in the survey. Example: PLUM0198-005 07/01/2014. PLUM is an abbreviation identifier of the union which prevailed in the survey for this classification, which in this example would be Plumbers. 0198 indicates the local union number or district council number where applicable, i.e., Plumbers Local 0198. The next number, 005 in the example, is an internal number used in processing the wage determination. 07/01/2014 is the effective date of the most current negotiated rate, which in this example is July 1, 2014.

Union prevailing wage rates are updated to reflect all rate changes in the collective bargaining agreement (CBA) governing this classification and rate.

Survey Rate Identifiers

Classifications listed under the "SU" identifier indicate that no one rate prevailed for this classification in the survey and the published rate is derived by computing a weighted average rate based on all the rates reported in the survey for that classification. As this weighted average rate includes all rates reported in the survey, it may include both union and non-union rates. Example: SULA2012-007 5/13/2014. SU indicates the rates are survey rates based on a weighted average calculation of rates and are not majority rates. LA indicates the State of Louisiana. 2012 is the year of survey on which these classifications and rates are based. The next number, 007 in the example, is an internal number used in producing the wage determination. 5/13/2014 indicates the survey completion date for the classifications and rates under that identifier.

Survey wage rates are not updated and remain in effect until a new survey is conducted.

Union Average Rate Identifiers

Classification(s) listed under the UAVG identifier indicate

that no single majority rate prevailed for those classifications; however, 100% of the data reported for the classifications was union data. EXAMPLE: UAVG-OH-0010 08/29/2014. UAVG indicates that the rate is a weighted union average rate. OH indicates the state. The next number, 0010 in the example, is an internal number used in producing the wage determination. 08/29/2014 indicates the survey completion date for the classifications and rates under that identifier.

A UAVG rate will be updated once a year, usually in January of each year, to reflect a weighted average of the current negotiated/CBA rate of the union locals from which the rate is based.

WAGE DETERMINATION APPEALS PROCESS

1.) Has there been an initial decision in the matter? This can be:

- * an existing published wage determination
- * a survey underlying a wage determination
- * a Wage and Hour Division letter setting forth a position on a wage determination matter
- * a conformance (additional classification and rate) ruling

On survey related matters, initial contact, including requests for summaries of surveys, should be with the Wage and Hour Regional Office for the area in which the survey was conducted because those Regional Offices have responsibility for the Davis-Bacon survey program. If the response from this initial contact is not satisfactory, then the process described in 2.) and 3.) should be followed.

With regard to any other matter not yet ripe for the formal process described here, initial contact should be with the Branch of Construction Wage Determinations. Write to:

Branch of Construction Wage Determinations
Wage and Hour Division
U.S. Department of Labor
200 Constitution Avenue, N.W.
Washington, DC 20210

2.) If the answer to the question in 1.) is yes, then an interested party (those affected by the action) can request review and reconsideration from the Wage and Hour Administrator (See 29 CFR Part 1.8 and 29 CFR Part 7). Write to:

Wage and Hour Administrator
U.S. Department of Labor
200 Constitution Avenue, N.W.
Washington, DC 20210

The request should be accompanied by a full statement of the interested party's position and by any information (wage payment data, project description, area practice material, etc.) that the requestor considers relevant to the issue.

3.) If the decision of the Administrator is not favorable, an interested party may appeal directly to the Administrative Review Board (formerly the Wage Appeals Board). Write to:

Administrative Review Board
U.S. Department of Labor
200 Constitution Avenue, N.W.
Washington, DC 20210

4.) All decisions by the Administrative Review Board are final.

=====

END OF GENERAL DECISION

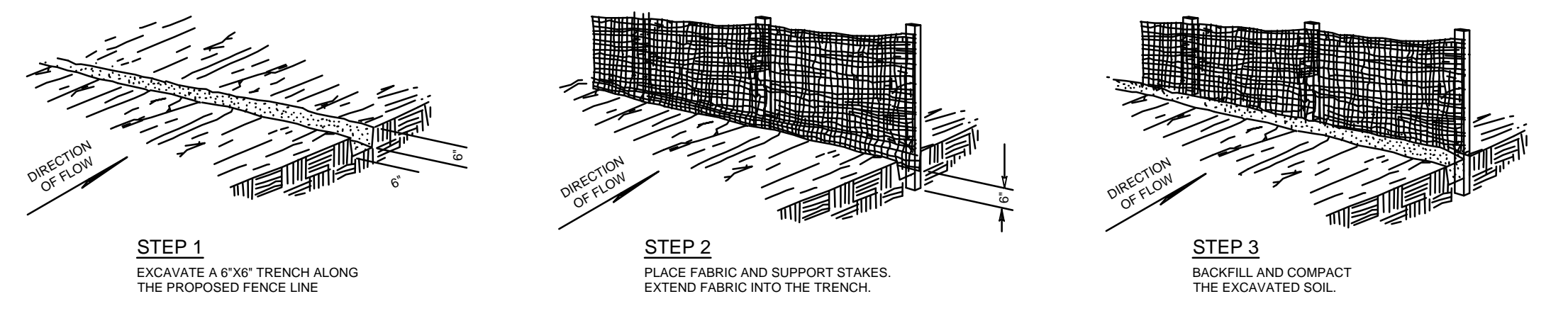
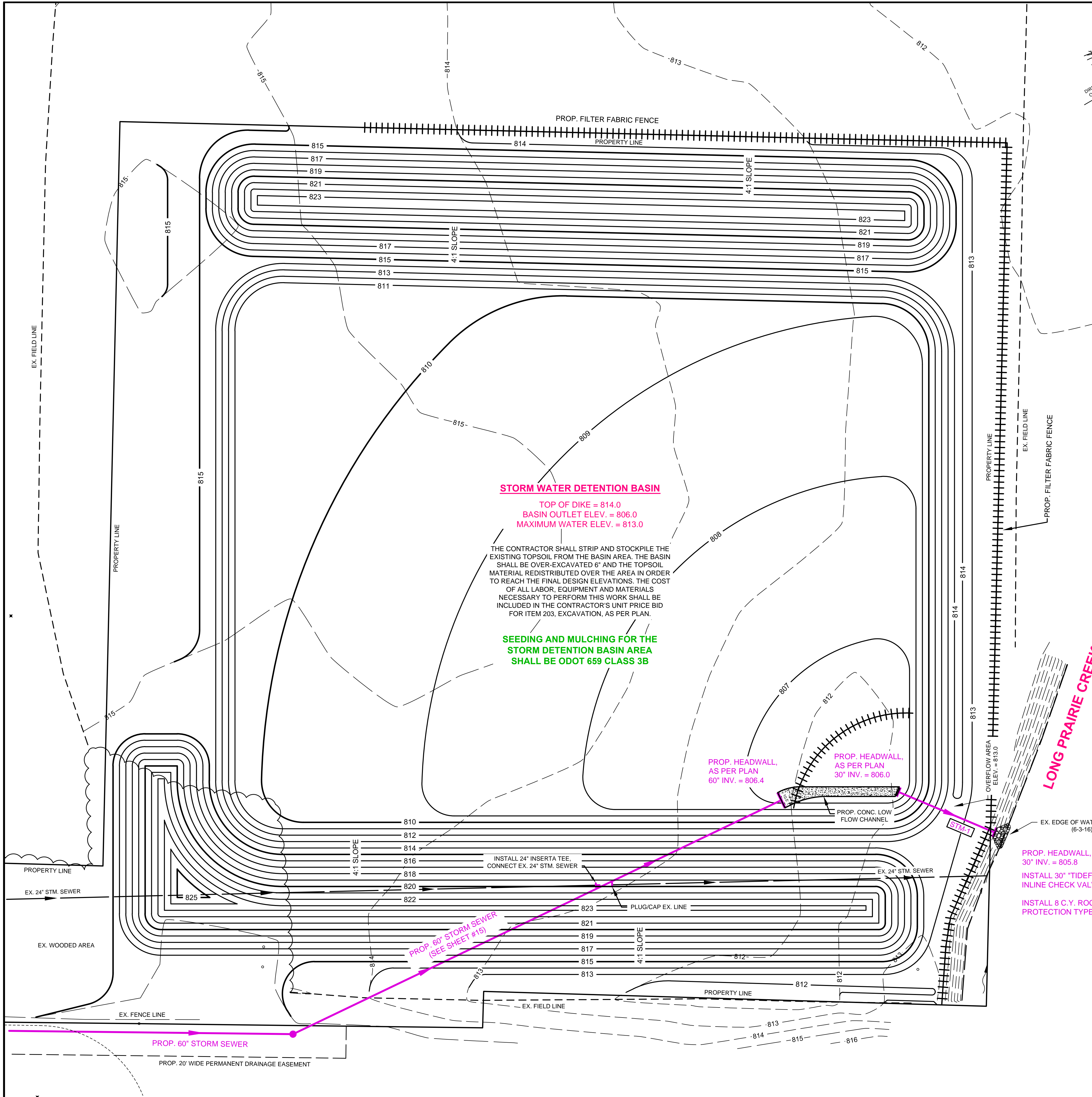

- SILT FENCE SHALL BE CONSTRUCTED BEFORE UPSLOPE LAND DISTURBANCE BEGINS.
 - ALL SILT FENCE SHALL BE PLACED AS CLOSE TO THE CONTOUR AS POSSIBLE SO THAT WATER WILL NOT CONCENTRATE AT LOW POINTS IN THE FENCE AND SO THAT SMALL SWALES OR DEPRESSIONS THAT MAY CARRY SMALL CONCENTRATED FLOWS TO THE SILT FENCE ARE DISSIPATED ALONG ITS LENGTH.
 - ENDS OF THE SILT FENCE SHALL BE BROUGHT UPSLOPE SLIGHTLY SO THAT WATER POUNDED BY THE SILT FENCE WILL BE PREVENTED FROM FLOWING AROUND THE ENDS.
 - SILT FENCE SHALL BE PLACED ON THE FLATTEST AREA POSSIBLE.
 - WHERE POSSIBLE, VEGETATION SHALL BE PRESERVED FOR 5' (OR AS MUCH AS POSSIBLE) UPSLOPE FROM THE SILT FENCE. IF VEGETATION IS REMOVED IT SHALL BE REESTABLISHED WITHIN 7 DAYS FROM THE INSTALLATION OF THE SILT FENCE.
 - THE HEIGHT OF THE SILT FENCE SHALL BE A MINIMUM OF 16" ABOVE THE ORIGINAL GROUND SURFACE.
 - THE SILT FENCE SHALL BE LOCATED IN AN EXCAVATED OR SLICED TRENCH CUT A MINIMUM OF 6" DEEP. THE TRENCH SHALL BE MADE WITH A TRENCHER, CABLE LAYING MACHINE, SLICING MACHINE, OR OTHER SUITABLE DEVICE THAT WILL ENSURE AN ADEQUATELY UNIFORM TRENCH DEPTH.
 - THE SILT FENCE SHALL BE PLACED WITH THE STAKES ON THE DOWNSLOPE SIDE OF THE GEOTEXTILE. A MINIMUM OF 8" OF GEOTEXTILE MUST BE BELOW THE GROUND SURFACE. EXCESS MATERIAL SHALL LAY ON THE BOTTOM OF THE 6" DEEP TRENCH. THE TRENCH SHALL BE BACKFILLED AND COMPACTED ON BOTH SIDES OF THE FABRIC.
 - SEAMS BETWEEN SECTIONS OF THE SILT FENCE SHALL BE SPICED TOGETHER ONLY AT A SUPPORT POST WITH A MINIMUM 6" OVERLAP PRIOR TO DRIVING THE POST INTO THE GROUND.
 - MAINTENANCE - THE SILT FENCE SHALL ALLOW RUNOFF TO PASS ONLY AS DIFFUSE FLOW THROUGH THE GEOTEXTILE. IF RUNOFF OVERTOPS THE SILT FENCE, FLOWS UNDER THE FABRIC OR AROUND THE FENCE ENDS, OR IN ANY OTHER WAY ALLOWS A CONCENTRATED FLOW DISCHARGE, ONE OF THE FOLLOWING SHALL BE PERFORMED, AS APPROPRIATE: 1) THE LAYOUT OF THE FENCE SHALL BE CHANGED, 2) ACCUMULATED SEDIMENT SHALL BE REMOVED, OR 3) OTHER PRACTICES SHALL BE INSTALLED.
- SEDIMENT DEPOSITS SHALL BE ROUTINELY REMOVED WHEN THE DEPOSIT REACHES APPROXIMATELY 1/2 OF THE HEIGHT OF THE SILT FENCE.
- THE SILT FENCE SHALL BE INSPECTED AFTER EACH RAINFALL AND AT LEAST DAILY DURING A PROLONGED RAIN EVENT. THE LOCATIONS OF EXISTING SILT FENCE SHALL BE REVIEWED DAILY TO ENSURE ITS PROPER LOCATION AND EFFECTIVENESS. IF DAMAGED, THE SILT FENCE SHALL BE REPAIRED IMMEDIATELY.
- CRITERIA FOR SILT FENCE MATERIALS:
- FENCE POST - THE LENGTH SHALL BE A MINIMUM OF 32". WOOD POSTS WILL 2"x2" IN NOMINAL DIMENSIONED HARDWOOD OF SOUND QUALITY. THEY SHALL BE FREE OF KNOTS, SPLITS AND OTHER VISIBLE IMPERFECTIONS, THAT WILL WEAKEN THE POSTS. THE MAXIMUM SPACING BETWEEN THE POSTS SHALL BE 10'. POSTS SHALL BE DRIVEN A MINIMUM OF 16" INTO THE GROUND, WHERE POSSIBLE. IF NOT POSSIBLE, THE POSTS SHALL BE ADEQUATELY SECURED TO PREVENT OVERTURNING OF THE FENCE DUE TO SEDIMENT/WATER LOADING.
 - SILT FENCE FABRIC - SEE CHART BELOW.

FABRIC PROPERTIES	VALUES	TEST METHOD
MINIMUM TENSILE STRENGTH	120 LBS (535 N)	ASTM D4632
MAXIMUM ELONGATION AT 60 LBS	50%	ASTM D4632
MINIMUM PUNCTURE STRENGTH	50 LBS (220 N)	ASTM D4833
MINIMUM TEAR STRENGTH	40 LBS (180 N)	ASTM D4533
APPARENT OPENING SIZE	<0.84 mm	ASTM D4751
MINIMUM PERMITTIVITY	1x10 ⁻² SEC.-1	ASTM D4491
UV EXPOSURE STRENGTH RETENTION	70%	ASTM G4355

FILTER FABRIC FENCE DETAIL
NO SCALE

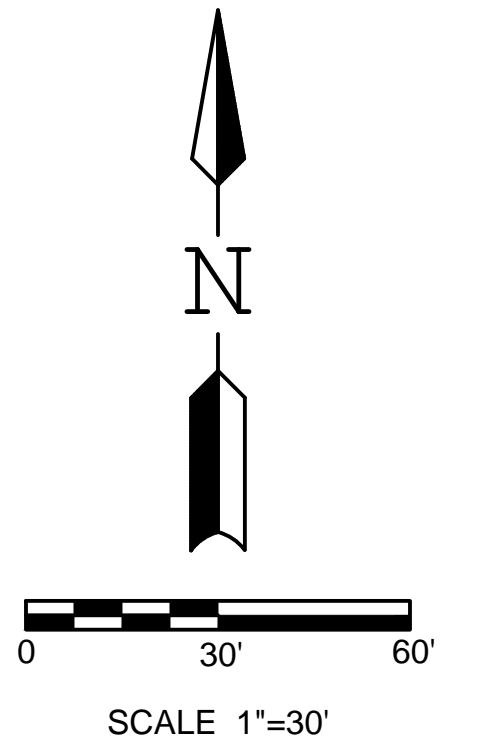

STORM WATER DETENTION BASIN

TOP OF DIKE = 814.0
BASIN OUTLET ELEV. = 806.0
MAXIMUM WATER ELEV. = 813.0

THE CONTRACTOR SHALL STRIP AND STOCKPILE THE EXISTING TOPSOIL FROM THE BASIN AREA. THE BASIN SHALL BE OVER-EXCAVATED 6" AND THE TOPSOIL MATERIAL REDISTRIBUTED OVER THE AREA IN ORDER TO REACH THE FINAL DESIGN ELEVATIONS. THE COST OF ALL LABOR, EQUIPMENT AND MATERIALS NECESSARY TO PERFORM THIS WORK SHALL BE INCLUDED IN THE CONTRACTOR'S UNIT PRICE BID FOR ITEM 203, EXCAVATION, AS PER PLAN.

SEEDING AND MULCHING FOR THE STORM DETENTION BASIN AREA SHALL BE ODOT 659 CLASS 3B

PROP. HEADWALL, AS PER PLAN
60" INV. = 806.4

PROP. HEADWALL, AS PER PLAN
30" INV. = 806.0

LONG PRAIRIE CREEK

STM-1 PROP. 65 L.F. - 30" STM. SEWER TYPE 'C' @ 0.31%

PROP. HEADWALL, AS PER PLAN
30" INV. = 805.8
INSTALL 30" TIDEFLEX CHECKMATE
INLINE CHECK VALVE" tideflex.com
INSTALL 8 C.Y. ROCK CHANNEL
PROTECTION TYPE 'B' W/FILTER

REVISED 9-2-16
REVISED 8-31-16

Mote & Associates
Engineering, Land Surveying
214 W. Fourth St., Greenville, OH 45331 937.548.7511 www.moteassociates.com

DETENTION BASIN SITE PLAN
STORM DRAINAGE IMPROVEMENTS
THE VILLAGE OF OHIO CITY

PROJ. NO: OC05044116	DWG. NO: 1D13703	SCALE: 1" = 30'
DRAWN: TJB	CHECKED: JLM	DATE: 8-11-16 SHEET NO: 6 OF 23